



CRNA GORA
GLAVNI GRAD- PODGORICA
**Sekretarijat za planiranje prostora
i održivi razvoj**

**SEKTOR ZA IZGRADNJU I
LEGALIZACIJU OBJEKATA**

Broj: D 08-332/20-547
Podgorica, 02.jul 2020.godine

na osnovu člana 74. Zakona o planiranju prostora i izgradnji objekata ("Sl.list CG" br.64/17), Uredbe o povjeravanju dijela poslova Ministarstva održivog razvoja i turizma jedinicama lokalne samouprave ("Službeni list Crne Gore" br.68/17 od 20.10.2017.godine), Detaljnog urbanističkog plana "Momišići B" usvojen od strane SO Podgorice Odlukom 02- 030 / 18 - 1502 od 27.12.2018. godine, evidentiran u Registru planske dokumentacije Ministarstva održivog razvoja i turizma na dan 02.jul 2020.godine, i podnijetog zahtjeva broj D 08-332/20 - 547.

IZDAJE URBANISTIČKO TEHNIČKE USLOVE
za izradu tehničke dokumentacije

CRNA GORA
GLAVNI GRAD PODGORICA
Sekretarijat za planiranje
prostora i održivi razvoj
Broj: D 08-332/20 - 547
Podgorica, 02. jul 2020. godine

DUP "Momišići B"
Urbanistička parcela broj UP b 244

URBANISTIČKO - TEHNIČKI USLOVI

za urbanističku parcelu broj UP b244,
Detaljnog urbanističkog plana "Momišići B"

PODNOŠILAC ZAHTJEVA:

Goran Knežević

POSTOJEĆE STANJE:

Prema grafičkim prilogima plana katastarska parcela broj 1628 KO:Tološi je izgrađena, uknjižena je porodična stambena zgrada, površine pod objektom 113m², spretnosti 1P.

U prilogu ovih urbanističko tehničkih uslova su i list nepokretnosti i kopija plana od 16.06.2020. godine.

Katastarska parcela broj 1628 KO:Tološi nalazi se u zahvatu DUP-a " Momišići B".

PLANIRANO STANJE:

DUP-om "Momišići B" formirana je urbanistička parcela broj **UP b244** koja prema analitičkim podacima površine je 697 m² i planirana za dokompletiranje.

Građevinska linija se utvrđuje u odnosu na regulacionu liniju i osovину saobraćajnice, a predstavlja liniju do koje je moguća gradnja.

Parcelaciju treba sprovesti prema grafičkom prilogu i analitičko – geodetskim .

USLOVI ZA PARCELACIJU

Pojedinačni uslovi su dati za svaku parcelu sa urbanističkim pokazateljima u tabelama.

Predloženi grafički plan parcelacije predstavlja definitivno rješenje na osnovu kojeg će se sprovesti planski dokument. Ukoliko na postojećim granicama parcela dođe do neslaganja između zvaničnog katastra i plana, mjerodavan je postojeći katastar.

Ukoliko vlasnici ne žele da ulaze u nove investicije i grade nove objekte planirane umjesto postojećih na istoj parceli, nisu obavezni da to rade.

Namjena, regulacija i nivelacija, gabariti i oblikovanje prostora:

DUP-om "Momišići B" na urbanističkoj parceli **UPb44**, planirana namjena površina je SMG stanovanje male gustine.

Postojeći objekat može se zadržati u postojećem gabaritu i spratnosti.

Postojeći objekti se mogu dograditi i nadograditi pod sledećim uslovima:

USLOVI ZA DOGRADNJU I NADOGRADNJU POSTOJEĆIH OBJEKATA

Uslovi iz ovog poglavlja se prevashodno odnose na postojeće stambene objekte. Ovi objekti se mogu dograditi i nadograditi pod uslovom da se:

- poštuju maksimalni planski parametri za datu urbanističku parcelu
- poštuju planirana horizontalna i vertikalna građevinska regulacija
- poštuju kompozicioni i oblikovni uslovi koji se odnose na zonu mješovite namjene
- poštuju propisano rastojanje objekta od susjedne urbanističke parcele u zoni stanovanja male gustine (4 metra)

USLOVI ZA OBJEKTE STANOVANJA MALE GUSTINE

U slučaju izgradnje planiranog objekta umjesto starog, moraju se poštovati građevinske linije na grafičkom prilogu.

Indeks zauzetosti u zoni stanovanja male gustine definisan je u zavisnosti od veličine parcele. Indeks progresivno opada sa rastom površine parcele da bi se spriječila izgradnja velikih objekata kolektivnog stanovanja u zoni stanovanja male gustine. Na osnovu statističke analize postojećeg građenog fonda i pripadajućih parcela formulisan je set opštih pravila za definisanje urbanističkih parametara:

Površina	zauzetost	P. osnove	izgrađenost
do 200	0.45	90	1.35
do 350	0.4	140	1.2
do 600	0.35	210	1.05
do 900	0.3	270	0.9
do 1200	0.25	300	0.75

Napomena: navedena formulacija urbanističkih parametara u odnosu na površinu urbanističke parcele predstavlja generalno plansko opredjeljenje i pokušaj da se raspon vrijednosti parametara postavi dovoljno fleksibilno da bi se primijenio na što veći broj stvarnih slučajeva. Na nivou plana kao cjeline predložena pravila su poslužila da se definišu parametri za integraciju postojećih i izgradnju novih objekata u zoni stanovanja male gustine. Ipak, u pojedinim slučajevima je došlo i do odstupanja. To se prvenstveno odnosi na one slučajeve u kojima površina parcele ima granične vrijednosti, ali i na slučajeve u kojima je priložena važeća građevinska dozvola izdata na osnovu prethodnog plana, kao i na objekte kojima u procesu legalizacije "nedostaje" nekoliko procenata BGP. Uopšte, činjenica da je prostor zahvata plana već izgrađen na gornjoj granici stanovanja male gustine, kao i da je veliki broj objekata građen sa prekoračenjem ili bez dozvole, uslovio je nemogućnost apsolutne primjene navedenih pravila koja bi bila moguća u slučaju planiranja neizgrađenog područja.

Na svim parcelama namijenjenim stanovanju male gustine, prema Pravilniku se mogu predvidjeti objekti koji ne ometaju osnovnu namjenu i koje služe svakodnevnim potrebama

stanovnika područja, i to:

- trgovina i ugostiteljski objekti, smještaj turista, poslovni sadržaji koji su smješteni u prizemljima i mezaninima stambenih objekata;
- objekti za upravu, kulturu, školstvo, zdravstvenu i socijalnu zaštitu, sport i rekreaciju i vjerski objekti koji služe svakodnevnim potrebama stanovnika područja;
- objekti i mreže infrastrukture;

- parkinzi i garaže za smještaj vozila korisnika (stanara i zaposlenih) i posjetilaca;

Za izgradnju objekata stanovanja male gustine (zone B, C i D) važe slijedeće smjernice:

- Preporučuje se izgradnja slobodnostojećih objekata manjih gabarita, utopljenih u zelenilo
- U slučaju izgradnje dvojnih objekata obavezno je pribavljanje zajedničke saglasnosti glavnog gradskog arhitekta na kompletan projekat za obje urbanističke parcele
- Zbog očuvanja rezidencijalnog karaktera naselja, **nije dozvoljena izgradnja privrednih i poslovnih objekata u funkciji proizvodnje, prerade, skladišta, stovarišta ili veleprodaje.**
- U jednom stambenom objektu može biti organizovano maksimalno 4 stambene jedinice
- Na većim parcelama moguće je planirane kapacitete opodijeliti na više objekata, tako da se ne prekorači ukupna planirana zauzetost, izgrađenost i BGP
- Na parceli se mogu graditi pomoćni objekti koji su u funkciji korišćenja stambenog objekta (garaža, ostava i sl), a čiji kapacitet ulazi u obračun ukupnih kapaciteta na parceli.
- Moguća je izgradnja **jedne podrumске ili suterenske etaže** koja se koristi **isključivo za garažiranje** i ne ulazi u obračun BGP.
- Podrum je podzemna etaža čiji vertikalni gabarit ne smije nadvisiti kotu terena, trotoara više od 1.00 m. Ukoliko se radi o denivelisanom terenu, relevantnom kotom terena smatra se najniža kota konačno uređenog i nivelisanog terena oko objekta. Horizontalni gabariti podruma definisani su građevinskom linijom ispod zemlje (GL 0) i ne mogu ni u kom slučaju preći regulacionu liniju. Ukupna površina podruma ne može biti veća od 80% površine urbanističke parcele, i to samo ako je zadovoljen minimalni procenat ozelenjenosti na parceli.
- Suterena je nadzemna etaža kod koje se dio vertikalnog gabarita nalazi iznad kote konačno nivelisanog terena oko objekta i čiji su horizontalni gabariti definisani građevinskom linijom GL. Suterena može biti na ravnom i na denivelisanom terenu. Kod suterena na ravnom terenu vertikalni gabarit ne može nadvisiti kotu terena više od 1.00 m konačno nivelisanog i uređenog terena oko objekta. Suterena na denivelisanom terenu je sa tri strane ugrađen u teren, s tim što se kota poda suterena na jednoj strani objekta poklapa sa kotom terena ili odstupa od kote terena maksimalno 1.00 m.
- Minimalna udaljenost svakog dijela objekta od granice parcele je 2 m. Ukoliko je rastojanje objekta od bočnog susjednog objekta veće od 5m, na bočnim fasadama objekta dozvoljeno otvaranje prozora samo pomoćnih prostorija, a ukoliko je rastojanje objekta od bočnog susjednog objekta veće od 7 m, na bočnim fasadama objekta dozvoljeno je otvaranje prozora stambenih prostorija
- Planom definisana minimalna rastojanja od granice parcele i susjednog objekta mogu biti i manja uz saglasnost vlasnika susjedne parcele, ali ne manja od 1m.
- Kota poda prizemlja može biti za stambene prostore od 0 do 1.20 m od kote konačno uređenog i nivelisanog terena oko objekta

- Visina nazidka potkrovnne etaže iznosi najviše 1.20 m računajući od kote poda potkrovnne etaže do tačke preloma krovne kosine.
- U oblikovnom smislu preporučuje se savremen, funkcionalan arhitektonski izraz i materijalizacija. Krovovi objekata mogu biti ravni ili kosi, nagiba do 25o; nije dozvoljeno izvođenje mansardnih krovova.
- u slučaju ograđivanja parcele koristiti laku metalnu i/ili živu ogradu, visine sokla do 50 cm. Nije dozvoljeno izvođenje zidanih ograda.

Pomoćni objekti:

- dozvoljena je izgradnja pomoćnih objekata na svakoj parceli stanovanja malih gustina ukoliko se ispoštuju uslovi u pogledu zauzetosti i kapaciteta i pod uslovom da ne ugrožava uslove korišćenja osnovnog i susjednih stambenih objekata.
- Pomoćnim objektima smatraju se garaže, spremišta i sl. ali i ekonomski objekti kao što su šupe, ljetnje kuhinje, spremišta poljoprivrednih proizvoda i sl.
- Udaljenje pomoćnog objekta od ivice parcele ne smije biti manje od 2.0 m. Rastojanje od granice parcele može biti i manje uz saglasnost vlasnika susjedne parcele, ali ne manja od 1m. Saglasnost ima trajni karakter bez obzira na eventualnu promjenu vlasnika.
- Moguće je graditi pomoćne objekte kao horizontalne dogradnje gabarita osnovnog objekta, pritom poštujući uslove za dogradnju postojećih objekata, kao i opšte uslove stambene izgradnje.

Uslovi za parkiranje vozila na parcelama stanovanja male gustine:

- Potreban broj parking mjesta treba obezbjediti u okviru parcele, na otvorenom, u garaži u sklopu ili van objekta.
- Kod objekata na nagnutom terenu, garaže se mogu graditi u sklopu uređenja dvorišta, u denivelaciji ispred objekta.
- Broj mjesta za parkiranje vozila se određuje po principu 1.1 PM na 1 stan

Pregled planiranih kapaciteta i urbanističkih parametara za svaku urbanističku parcelu:

PARCELA			POSTOJEĆE				
BR UP	NAMJENA	POVRSINA	Povrsina postojecih objekata	BGP postojecih objekata	Broj postojecih objekata	Postojeca zauzetost	Postojeca izgradjenost
UP b244	SMG	697	113	170	1	0.16	0.24

PLANIRANO					
Max. spratnost	Max. zauzetost	Max. izgrađenost	Max. BGP	Max. broj stanova	Max. BGP poslovanja
P+2	0.35	0.88	610	4	244

Uslovi za priključak na saobraćajnu i komunalnu infrastrukturu

Na urbanističku parcelu mora se projektovati i obezbijediti kolski pristup sa gradske saobraćajnice ili javnog puta.

Nesmetan pristup i kretanje licima smanjene pokretljivosti u skladu sa Pravilnikom o bližim uslovima i načinu prilagođavanja objekata za pristup i kretanje lica smanjene pokretljivosti i lica sa invaliditetom br. 05-412/86 od 10/ 2013. Godine, Službeni list Crne Gore, br.48/13 I 44/15.

Planira se parkiranje u okviru svake urbanističke parcele, unutar parcele ili u garaži / ispod objekta u podrumskoj etaži / u skladu sa Pravilnikom o bližem sadržaju i formi planskog dokumenta ,kriterijumima namjene površina, elementima urbanističke regulacije i jedinstvenim grafičkim simbolima ("Službeni list CG", br. 24/10).

Na urbanističku parcelu moraju se obezbijediti komunalni priključci, na vodovodnu, elektroenergetsku i telekomunikacionu mrežu i priključenje na kanalizaciju prema uslovima planiranim ovim planom i uslovima nadležnih javnih preduzeća za oblast infrastrukture.

Uslovi za zaštitu i unapredjenje životne sredine

- u cilju racionalnog korišćenja energije treba iskoristiti sve mogućnosti smanjenja korišćenja energije. Pri izgradnji koristiti savremene termoizolacione materijale, kao bi se smanjila potrošnja toplotne energije;
- predvidjeti mogućnost korišćenja solarne energije;
- kao sistem protiv pretjerane insolacije koristiti održive sisteme (zasjenu škurama, građevinskim elementima, zelenilom i dr.) kako bi se smanjila potrošnja energije za vještačku klimatizaciju;
- drvoredima smanjiti uticaj vjetrova i obezbijediti neophodnu zasjenu u ljetnjim mjesecima;
- suspenziju smeća i otpada vršiti u okviru organizacije komunalne djelatnosti.

Mjere energetske efikasnosti

Poboljšanje energetske efikasnosti posebno se odnosi na ugradnju ili primjenu: niskoenergetskih zgrada, unaprijeđenje uređaja za klimatizaciju i pripremu tople vode korišćenjem solarnih panela za zagrijavanje, unaprijeđenje rasvjete upotrebom izvora svjetla sa malom instalisanom snagom (LED), koncepta inteligentnih zgrada (upravljanje potrošnjom energije glavnih potrošača sa centralnog mjesta). Sve nabrojane mogućnosti se u mogu koristiti pri izgradnji objekata na području zahvata.

Za izvedbu objekata uz navedene energetske mjere potrebno je primjenjivati (uz prethodnu pripremu stručnu i zakonodavnu) Direktivu 2002/91/EC Evropskog parlamenta (Directive 2002/91/EC of the European Parliament and of the Council of 16 December 2002 on the energy performance of buildings (Official Journal L 001,04/01/2003)/ o energetskim svojstvima zgrada, što podrazumijeva obavezu izdavanja certifikata o energetskim svojstvima zgrade, kome rok valjanosti nije duži od 10 god.

Korišćenje solarnih kolektora se preporučuje kao mogućnost određene uštede u potrošnji električne energije, pri čemu se mora povesti računa da ne budu u koliziji sa karakterističnom tradicionalnom arhitekturom.

Za proizvodnju električne energije pomoću fotonaponskih elemenata, potrebno je uraditi rethodnu sveobuhvatnu analizu tehničkih, ekonomskih i ekoloških parametara.

UREĐENJE TERENA:

Sastavni dio projektne dokumentacije je i projekat uređenja terena za pripadajuću lokaciju. Istim će se definisati svi potrebni sadržaji koji obuhvataju: unutrašnje saobraćajne površine, hortikulturno uređenje sa urbanom opremom i mobilijarom.

Lokaciju nivelisati tako da se pristupnom saobraćajnicom i susjednim parcelama predstavlja prostornu cjelinu, uz uslova da projektovani nagibi riješe pitanje odvodnjavanja površinskih voda prema ulici.

Obradom površina partera izvršiti njegovu diferencijaciju po nemjeni, uz primjenu trajnih, savremenih materijala, i obezbijediti jedinstvo sa prostornim cjelinama objekata u zoni.

Zelenilo individualnih stambenih objekata

Zelenilo u okviru stambenih objekata podrazumijeva uređenje slobodnih površina oko objekta u zavisnosti od orijentacije kuće i njenog položaja na parceli. Osnovna pravila uređenja okućnice su da kuća bude na 1/3 placa, bliže ulici, gdje dobijemo predvrt koji ima estetsku ulogu i sadrži kolski prilaz, parking, rasvjetu i sl. Zadnji vrt služi kao prostor za odmor i ako je parcela veća kao ekonomski dio dvorišta.

Smjernice za pejzažno uređenje i izdavanje UT uslova

- zelene površine treba da zahvataju min. 40% površine parcele;
- min. visina sadnice 2,5-3m;
- min. obim sadnice na visini 1m od 10-15cm;
- kompoziciju vrta stilski uskladiti sa arhitekturom objekta;
- pri odabiru zasada voditi računa o uslovima sredine, dimenzijama, boji, oblicima;

- za izradu staza i stepenica koristiti materijale koji su dostupni u najbližem okruženju;
- predvrt urediti reprezentativno u okviru kojeg razmotriti riješenje formiranja parkinga;
- razdvajanje parcela i izolaciju od saobraćajne buke riješiti podizanjem zasada žive ograde;
- tamo gdje nema mjesta za sadnju drveća i žbunja planirati **vertikalno i krovno zelenilo**, kao isadnju u žardinjerama radi povećanja nivoa ozelenjenosti i što potpunijeg estetskogdoživljaja prostora;
- vertikalno ozelenjavanje sprovesti ozelenjavanjem fasada kuća, terasa, potpornih zidova, u vidu zelenih portala na ulazima u objekat i primjenom pergola;
- na objektima sa ravnim krovom poželjno je planirati krovno ozelenjavanje uz neophodnu pripremu izolacione podloge specifične za ovaj vid ozelenjavanja.

ETAPNOST REALIZACIJE:

Moguća je i fazna realizacija a što je potrebno definisati kroz tehničku dokumentaciju.

OSTALI USLOVI:

1. Proračune za objekat raditi na IX (deveti) stepen seizmičkog intenziteta po MCS skali. Projektom predvidjeti sve potrebne mjere zaštite od požara, kao i druge uslove za zaštitu od elementarnih nepogoda i tehničko-tehnoloških i drugih nesreća, u skladu sa vežećim propisima i od nadležnog organa pribaviti saglasnost na isti.
2. Ukoliko se planira djelatnost koja može imati značajni uticaj na životnu sredinu i zdravlje ljudi, potrebno je projekat uskladiti sa Zakonom o procjeni uticaja na životnu sredinu odnosno pristupiti izradi Elaborata u skladu sa navedenim Zakonom.
3. Potrebno je omogućiti pristup licima smanjene pokretljivosti i licima sa invaliditetom u sve objekte koji svojom funkcijom podrazumijevaju prisustvo građana. Kroz objekte gdje je omogućen rad licima sa invaliditetom neophodno je obezbijediti uslove za njihovo nesmetano kretanje, rad i boravak, u skladu sa važećim zakonskim propisima.
4. Prije izrade tehničke dokumentacije investitor je obavezan, shodno članu 7 Zakona o geološkim istraživanjima („Sl.list RCG", broj 28/93, 27/94 i 26/07) izraditi Projekat o geološkim istraživanjima i obezbijediti Elaborat o rezultatima izvršenih geomehaničkih istraživanja tla za predmetnu lokaciju.
5. Područje Podgorice karakteriše submediteranska klima sa vrlo dugim, toplim i sušnim ljetima, a blagim i kišovitim zimama. Višegodišnjom analizom meteoroloških uslova utvrđeno je da Podgorica ima:
 - srednju godišnju temperatutu od 15,5%^oC (prosječno najhladniji mjesec je januar sa 5%^oC), a najtopliji jul sa 26,7%^oC),
 - 2450 sunčanih sati (102 dana), (najsunčaniji mjesec je juli, a najmanje sunčan mjesec je decembar),
 - srednji godišnji prosjek padavina od 169 mm (najveši u decembru 248 mm, najmanji u julu 42 mm),
 - prosječnu relativnu godišnju vlažnost vazduha 63,6% (max. vlažnost je u novembru 77,2%, a min. u julu 49,4%),

- dominantan sjeverni vjetar sa max. brzinom od 34,80 m/sec (123km/h), sa pritiskom od 75,7 kp/m², najčešće u zimskom periodu sa prosječno 20,8 dana,
- srednji vremenski period u kome je potrebno grijanje je od 10. novembra do 30. marta. Prije projektovanja navedene podatke potrebno je provjeriti i kompletirati od Republičkog hidrometeorološkog zavoda Podgorica.

6. Glavni projekat raditi u skladu sa ovim uslovima, uslovima javnih preduzeća za oblast infrastrukture, važećem Zakonu, vežećim tehničkim propisima, normativima i standardima za projektovanje, izgradnju i korišćenje ove vrste objekata, a na osnovu projektnog zadatka investitora.

INFRASTRUKTURA:

7. Projektovanje elektroenergetskih instalacija i napajanje predmetnog objekta električnom energijom izvesti prema grafičkom prilogu ovih uslova. Električne instalacije projektovati i izvesti u skladu sa vežećim propisima i standardima i na iste pribaviti saglasnost od nadležnog preduzeća. Mjesto i način priključenja objekta na elektroenergetsku mrežu odrediće nakon izrade projektne dokumentacije stručne službe CEDIS-a.

8. Instalacije vodovoda i kanalizacije projektovati u svemu prema važećim propisima i normativima za tu vrstu objekata, a priključiti ih na gradsku distributivnu mrežu prema uslovima d.o.o. "Vodovod i kanalizacija" - Podgorica.

U prilogu se daju trase postojećih i DUP-om planiranih vodova.

Projekat hidrotehničkih instalacija raditi u skladu sa važećim tehničkim propisima i normativima.

9. Priključenje predmetnog objekta na tk mrežu investitor će izvesti prema grafičkom prilogu ovih uslova. Tk instalacije projektovati i izvesti u skladu sa vežećim propisima i standardima i na iste pribaviti saglasnost od nedležnog preduzeća.

OBRADILI :

Arh. Beti Radović, dipl. ing.

Obrada grafičkih priloga :
Vlatko Mijatović, teh.

Vlatko Mijatović

OVLAŠĆENO SLUŽBENO LICE II
ZA IZGRADNJU I LEGALIZACIJU OBJEKATA

Arh. Beti Radović, dipl. ing.

PRILOZI:

- Grafički prilozi iz planskog dokumenta
- Tehnički uslovi u skladu sa posebnim propisima
- List nepokretnosti i kopija katastarskog plana

CRNA GORA
UPRAVA ZA NEKRETNINE
PODRU^NA JEDINICA: PODGORICA
Broj: 958-101-2096/2020
Datum: 16.06.2020.



Katastarska opština: TOLOJ
Broj lista nepokretnosti: 560
Broj plana: 26,58
Parcela: 1628

KOPIJA PLANA

Razmjera 1: 1000

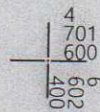
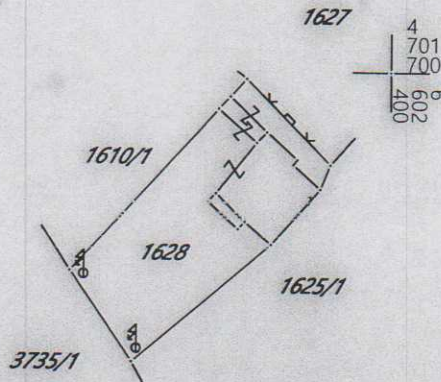

IZVOD IZ DIGITALNOG PLANA
Obradio:





UPRAVA ZA NEKRETNINE

PODRUČNA JEDINICA
PODGORICA

Broj: 101-956-21400/2020

Datum: 11.06.2020.

KO: TOLOŠI

Na osnovu člana 173 Zakona o državnom premjeru i katastru nepokretnosti ("Sl. list RCG" br. 29/07, "Sl. list CG" br. 73/10, 032/11, 040/11, 043/15, 037/17 i 17/18), postupajući po zahtjevu sekretarijat za planiranje prostora i održivi 958-101-2096/20, , za potrebe izdaje se

LIST NEPOKRETNOSTI 560 - PREPIS

Podaci o parcelama

Broj	Podbroj	Broj zgrade	Plan Skica	Datum upisa	Potes ili ulica i kućni broj	Način korišćenja Osnov sticanja	Bon. klasa	Površina m ²	Prihod
1628			28 210		TOLOŠI	Dvorište		469	0.00
1628		1	28 210		TOLOŠI	Porodična stambena zgrada		113	0.00
Ukupno								582	0.00

Podaci o vlasniku ili nosiocu

Matični broj - ID broj	Naziv nosioca prava - adresa i mjesto	Prava	Obim prava
1012963210010	KNEŽEVIĆ RADONJA GORAN BUL. SVETOG PETRA CETINJSKOG 54 Podgorica	Svojina	1/1

Podaci o objektima i posebnim djelovima

Broj	Podbroj	Broj zgrade	Način korišćenja Osnov sticanja Sobnost	PD Godina izgradnje	Spratnost/ Sprat Površina	Prava Vlasnik ili nosilac prava Adresa, Mjesto
1628		1	Porodična stambena zgrada GRADENJE	981	P 113	/
1628		1	Garaža kao dio zgrade GRADENJE 1	1	1P 55	Svojina KNEŽEVIĆ RADONJA GORAN 1/1 1012963210010 BUL. SVETOG PETRA CETINJSKOG
1628		1	Stambeni prostor GRADENJE 30	2	P 92	Svojina KNEŽEVIĆ RADONJA GORAN 1/1 1012963210010 BUL. SVETOG PETRA CETINJSKOG

Podaci o teretima i ograničenjima

Broj	Podbroj	Broj zgrade	PD	Redni broj	Način korišćenja	Datum upisa Vrijeme upisa	Opis prava
1628		1		1	Porodična stambena zgrada	19/05/2020 10:39	PRAVO DOŽIVOTNOG PLODOUŽIVANJA NA PRIZEMNOM I POLUSPRATNOG DIJELU KUĆE U KORIST KNEŽEVIĆ RADONJE I KNEŽEVIĆ STANE

Naplata takse je oslobođena na osnovu člana 17 Zakona o administrativnim taksama ("Sl.list CG, br. 18/19). Naplata naknade oslobođena je na osnovu člana 174 Zakona o državnom premjeru i katastru nepokretnosti ("Sl. list RCG" br. 29/07, "Sl. list CG" br. 73/10, 032/11, 040/11, 043/15, 037/17 i 17/18).

Načelnik
Marko Bulatović
Marko Bulatović, dipl. prav
UP
Pod

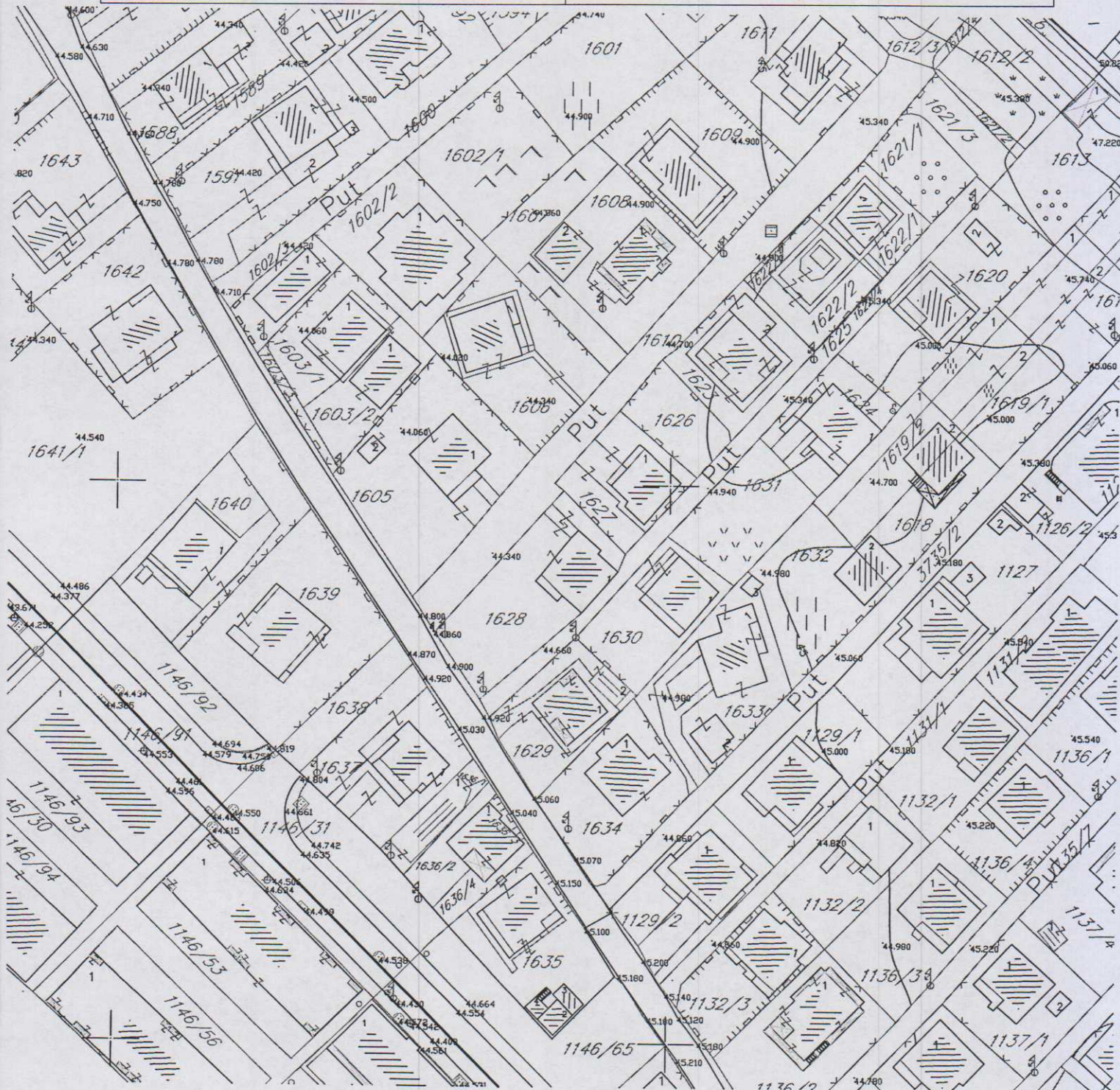
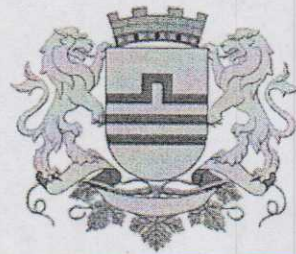

GRAFIČKI PRILOG –Geodetska podloga

Izvod iz DUP-a „Momišići B“ u Podgorici
za urbanističku parcelu UP B244

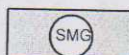
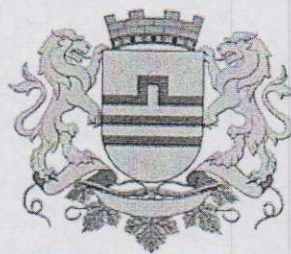

Površine za stanovanje male gustine

GRAFIČKI PRILOG –Postojeća namjena površina

Izvod iz DUP-a „Momišići B “ u Podgorici
za urbanističku parcelu UP B244

02

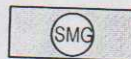
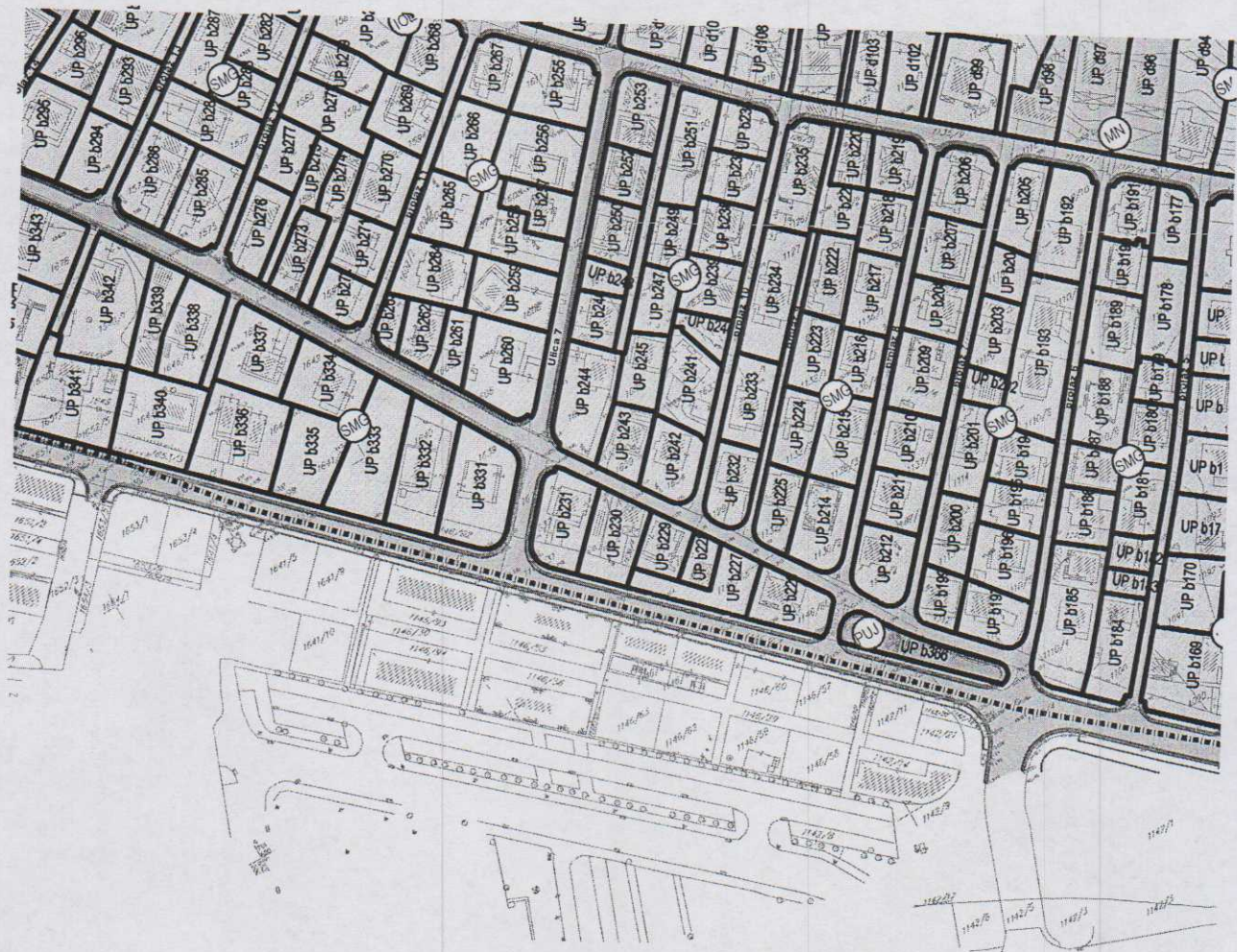
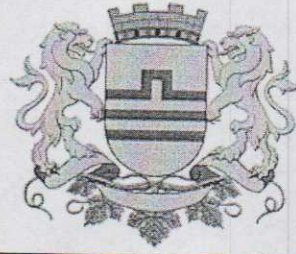

Površine za stanovanje male gustine

GRAFIČKI PRILOG –Plan namjene površina

Izvod iz DUP-a „Momišići B “ u Podgorici
za urbanističku parcelu UP B244

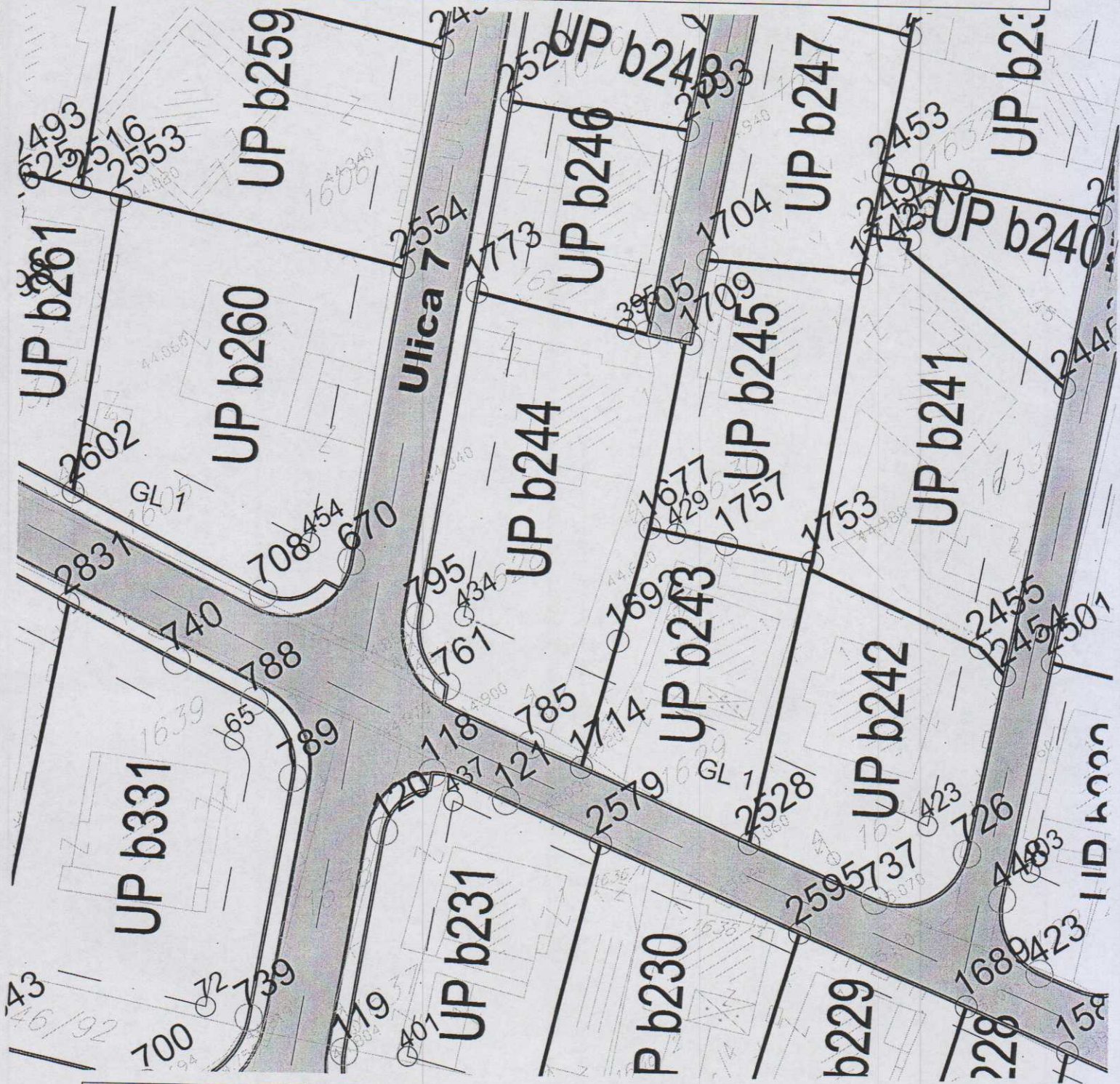

GRAFIČKI PRILOG –Plan parcelacije, regulacije i nivelacije

Izvod iz DUP-a „Momišići B“ u Podgorici
za urbanističku parcelu UP B244

KOORDINATE TJEMENA GRAĐEVINSKIH LINIJA

1	6603209.15	4701035.07
2	6603248.03	4701124.76
3	6603226.72	4701116.32
4	6603222.64	4701067.73
5	6603182.13	4701064.98
6	6603175.70	4701050.33
7	6603201.24	4701056.26
8	6603202.67	4701127.33
9	6603208.39	4701124.68
10	6602145.16	4701983.41
11	6603139.42	4701142.09
12	6603141.36	4701146.35
13	6602088.12	4702045.11
14	6602100.70	4702223.53
15	6603215.16	4701139.44
16	6603123.79	4701152.16
17	6602205.85	4702199.78
18	6603207.62	4701074.66
19	6603209.29	4701141.90
20	6603191.07	4701144.86
21	6603193.30	4701149.29
22	6603162.64	4701158.00
23	6603160.74	4701153.86
24	6602373.40	4701841.54
25	6603162.17	4701136.86
26	6602124.83	4702288.88
27	6602275.85	4701819.28
28	6602289.02	4701761.77
29	6602260.04	4701752.24
30	6603222.61	4701107.08
31	6603163.73	4701139.87
32	6603152.58	4701157.63
33	6602326.41	4701940.77
34	6602561.28	4701654.72
35	6603186.16	4701134.96
36	6603184.12	4701130.45
37	6602222.10	4702183.90
38	6602587.84	4701631.91
39	6602541.09	4701568.39
40	6602251.94	4701816.90

41	6602216.91	4701789.63
42	6602131.71	4702075.80
43	6602345.62	4701881.01
44	6602174.66	4702140.13
45	6602140.94	4702165.62
46	6602169.97	4702008.68
47	6602182.00	4702018.74
48	6602093.88	4702235.67
49	6602068.22	4702269.03
50	6602123.02	4702293.39
51	6602480.04	4701537.36
52	6602140.52	4702173.36
53	6602186.40	4702216.65
54	6602101.35	4702318.71
55	6602366.63	4701851.49
56	6602293.32	4701793.84
57	6602108.87	4702318.64
58	6602247.91	4702049.44
59	6602264.53	4702021.53
60	6602169.77	4701947.93
61	6602530.10	4701554.54
62	6602220.26	4701888.44
63	6602314.12	4701957.49
64	6602227.55	4701782.71
65	6602340.83	4701675.96
66	6602429.52	4701580.71
67	6602524.95	4701685.92
68	6602248.48	4701856.10
69	6602284.04	4701887.05
70	6602240.62	4701865.60
71	6602353.90	4701872.12
72	6602326.16	4701656.64
73	6602252.78	4701729.86
74	6601894.85	4702030.34
75	6601910.77	4702063.04
76	6602248.28	4701945.38
77	6602282.50	4701772.02
78	6602258.79	4701807.03
79	6602466.15	4701521.58
80	6602463.22	4701599.88

81	6602125.13	4702158.77
82	6602399.22	4701808.51
83	6602321.94	4701744.13
84	6602470.79	4701544.99
85	6602439.64	4701559.50
86	6602106.00	4702141.54
87	6602091.76	4702129.62
88	6602052.86	4702085.53
89	6602044.62	4702095.74
90	6602250.06	4701732.57
91	6602170.53	4701811.95
92	6601999.84	4702347.20
93	6602023.25	4702386.08
94	6602039.83	4702101.92
95	6602032.64	4702111.78
96	6602534.68	4701677.57
97	6602466.86	4701603.85
98	6602219.66	4701857.66
99	6601960.68	4702291.11
100	6602067.65	4702113.64
101	6602463.75	4701536.83
102	6602166.94	4702127.16
103	6602472.66	4701528.80
104	6601969.50	4702073.10
105	6602267.87	4701938.36
106	6602245.37	4701970.41
107	6602113.01	4702161.31
108	6602039.64	4702168.89
109	6602076.37	4702200.47
110	6601990.82	4702264.61
111	6602099.31	4702148.97
112	6602085.63	4702137.52
113	6602141.29	4702099.98
114	6602111.87	4702079.26
115	6602000.80	4702263.32
116	6601979.45	4702275.84
117	6601878.99	4702041.41
118	6602189.50	4702130.51
119	6602251.60	4702071.93
120	6602023.80	4702123.87

121	6602195.39	4702007.69
122	6602075.76	4702354.27
123	6602090.69	4702338.77
124	6601970.49	4702029.90
125	6601946.81	4701997.71
126	6601937.06	4702261.70
127	6601974.25	4702153.00
128	6602023.81	4702089.84
129	6602085.28	4702190.10
130	6602258.20	4701931.25
131	6602210.59	4701896.22
132	6602494.54	4701494.42
133	6602539.23	4701546.74
134	6602537.43	4701525.20
135	6602517.17	4701498.13
136	6602031.62	4702388.36
137	6601920.57	4702235.86
138	6602283.62	4702089.61
139	6602079.07	4702054.33
140	6602207.92	4702096.18
141	6602238.86	4702063.97
142	6601987.24	4702170.00
143	6602017.31	4702134.03
144	6601971.52	4702086.90
145	6601960.53	4702073.00
146	6601875.86	4702022.98
147	6601863.74	4701995.60
148	6601987.01	4702179.09
149	6602051.01	4702257.23
150	6602002.21	4702257.58
151	6602149.34	4701862.89
152	6601991.87	4702055.00
153	6601999.99	4702063.86
154	6601839.12	4702065.44
155	6601994.79	4702212.26
156	6601953.21	4702205.33
157	6601933.12	4702225.31
158	6602137.06	4701891.02
159	6601954.70	4701985.65
160	6601981.36	4702021.91
161	6601978.81	4702224.55
162	6601786.80	4701934.62

163	6601762.01	4701953.91
164	6602023.13	4701931.82
165	6601960.58	4702221.89
166	6601986.48	4702202.12
167	6602523.49	4701492.60
168	6602541.58	4701522.29
169	6601761.23	4701870.11
170	6601861.21	4702032.73
171	6601710.16	4701874.62
172	6601754.37	4701942.24
173	6602214.88	4702157.84
174	6602157.39	4701887.02
175	6602150.71	4701880.71
176	6601987.41	4702000.05
177	6601817.96	4702039.47
178	6602185.25	4701896.85
179	6602211.67	4701866.61
180	6601929.52	4702199.27
181	6601961.33	4702167.62
182	6601998.45	4701947.95
183	6601917.58	4702209.28
184	6601984.22	4701988.14
185	6602000.24	4701985.34
186	6602128.40	4701882.69
187	6602172.29	4702254.05
188	6601826.58	4702052.86
189	6601914.65	4701885.98
190	6602550.76	4701561.27
191	6601837.68	4702070.75
192	6602138.43	4701952.58
193	6602178.80	4701904.52
194	6602669.94	4701607.13
195	6601854.47	4701797.16
196	6601857.81	4701795.44
197	6602197.41	4702146.70
198	6601945.74	4702136.01
199	6601851.02	4702039.07
200	6601771.32	4701839.23
201	6601711.54	4701869.47
202	6602055.61	4702391.02
203	6602086.56	4702364.68
204	6602162.03	4701820.43

205	6601779.37	4701922.53
206	6601750.82	4701876.09
207	6601943.80	4701967.09
208	6602142.47	4702295.95
209	6602032.21	4702079.02
210	6602032.19	4701965.10
211	6602077.38	4701922.10
212	6602096.66	4701940.20
213	6601983.88	4701992.39
214	6602231.39	4702173.08
215	6602286.87	4702107.08
216	6601994.59	4702037.99
217	6602218.30	4702214.13
218	6602241.52	4702190.55
219	6602508.15	4701722.76
220	6602086.87	4701913.75
221	6602077.44	4701899.39
222	6602065.29	4701906.58
223	6602081.83	4702019.95
224	6602127.00	4701966.19
225	6601898.54	4701897.24
226	6601884.02	4701905.76
227	6601887.68	4702009.56
228	6602442.95	4701785.18
229	6602466.12	4701811.44
230	6602038.02	4702047.80
231	6602038.41	4702071.64
232	6601997.24	4702003.57
233	6602280.84	4702027.35
234	6602307.86	4702044.63
235	6602048.02	4702060.20
236	6602073.07	4702030.39
237	6601830.80	4701809.14
238	6602070.00	4701928.90
239	6602056.61	4701911.71
240	6601924.62	4701839.79
241	6602617.81	4701629.10
242	6601895.15	4701907.30
243	6602267.61	4702041.77
244	6602275.43	4702028.63
245	6602111.67	4701947.96
246	6602101.67	4701958.62

247	6602326.97	4702069.48
248	6602311.39	4702088.01
249	6601902.23	4701866.18
250	6601870.01	4701788.68
251	6601912.53	4701860.04
252	6601783.39	4701833.12
253	6601959.15	4701953.36
254	6602407.22	4701901.00
255	6601985.16	4701931.68
256	6601864.14	4701888.13
257	6601968.21	4701945.31
258	6602849.07	4701506.47
259	6602340.36	4701946.41
260	6602352.82	4701907.63
261	6601924.67	4701879.37
262	6602304.84	4702055.69
263	6602864.08	4701499.99
264	6602484.40	4701744.43
265	6601938.80	4701966.30
266	6602635.64	4701628.14
267	6602265.71	4702060.28
268	6602324.61	4701968.96
269	6602602.61	4701641.63
270	6602385.45	4701901.58
271	6603091.80	4701204.43
272	6602398.13	4701870.27
273	6601885.14	4701779.24
274	6602408.87	4701863.18
275	6602388.05	4701846.82
276	6602381.17	4701856.72
277	6602368.49	4701876.87
278	6602920.84	4701440.92
279	6602863.68	4701453.03
280	6602779.28	4701438.98
281	6602751.58	4701533.89
282	6602892.90	4701484.08
283	6602886.53	4701485.46
284	6602830.19	4701479.69
285	6602757.39	4701531.01
286	6602842.70	4701469.66
287	6602958.36	4701266.27
288	6602678.30	4701620.77

289	6602453.59	4701776.08
290	6602477.67	4701803.36
291	6602647.97	4701649.99
292	6602001.27	4701918.89
293	6602027.81	4701903.19
294	6602941.06	4701387.22
295	6602975.92	4701282.52
296	6602894.22	4701342.88
297	6603087.81	4701203.00
298	6603056.29	4701217.94
299	6602634.66	4701658.95
300	6601968.46	4701818.77
301	6602952.66	4701379.75
302	6602361.76	4701887.97
303	6602630.64	4701619.28
304	6601995.63	4701917.58
305	6601942.92	4701837.58
306	6602871.52	4701330.43
307	6602796.14	4701386.11
308	6602876.67	4701367.03
309	6602799.94	4701423.71
310	6602788.12	4701432.44
311	6602809.60	4701416.58
312	6602912.39	4701413.88
313	6602921.13	4701166.45
314	6602643.51	4701642.08
315	6602972.90	4701257.46
316	6602618.91	4701601.72
317	6603009.66	4701126.07
318	6603033.13	4701115.36
319	6602994.54	4701363.65
320	6603052.56	4701294.27
321	6602786.10	4701483.86
322	6602762.12	4701451.65
323	6602904.13	4701437.20
324	6602910.70	4701442.13
325	6603016.71	4701317.33
326	6602961.78	4701394.10
327	6602988.26	4701371.37
328	6603031.01	4701257.03
329	6602979.93	4701281.24
330	6602916.82	4701436.30

331	6602675.31	4701335.07
332	6602742.71	4701425.59
333	6603133.76	4701186.95
334	6602871.94	4701360.58
335	6602917.11	4701382.30
336	6602913.83	4701385.50
337	6602901.79	4701176.19
338	6602925.91	4701209.24
339	6602731.97	4701300.13
340	6602940.29	4701349.70
341	6602812.12	4701465.52
342	6602722.00	4701300.99
343	6602789.71	4701390.86
344	6602824.70	4701456.66
345	6603025.90	4701331.63
346	6603051.58	4701315.12
347	6602572.04	4701424.25
348	6602672.37	4701564.02
349	6603022.72	4701333.77
350	6602925.99	4701424.09
351	6602903.14	4701477.77
352	6602834.51	4701449.75
353	6602947.58	4701403.30
354	6602940.50	4701408.72
355	6602950.02	4701362.43
356	6603001.64	4701354.20
357	6602988.04	4701344.00
358	6602980.94	4701353.45
359	6602584.43	4701556.04
360	6602898.39	4701372.78
361	6602883.95	4701351.71
362	6602912.15	4701368.98
363	6602905.37	4701423.24
364	6602902.65	4701426.85
365	6602607.53	4701539.24
366	6602761.75	4701501.03
367	6602773.02	4701493.09
368	6602876.68	4701440.23
369	6602831.00	4701400.76
370	6602853.70	4701432.56
371	6602812.51	4701241.35
372	6602748.67	4701510.25

373	6602644.37	4701365.82
374	6602485.85	4701502.73
375	6602535.75	4701487.90
376	6602520.82	4701469.35
377	6602592.63	4701564.93
378	6602624.30	4701541.86
379	6602735.80	4701524.21
380	6602719.81	4701535.48
381	6603002.38	4701129.39
382	6603049.06	4701221.36
383	6602542.63	4701450.28
384	6602710.00	4701542.40
385	6602605.45	4701397.02
386	6602499.25	4701708.00
387	6602803.13	4701471.86
388	6602614.82	4701389.51
389	6602511.73	4701477.99
390	6602821.35	4701407.90
391	6602845.63	4701441.91
392	6602605.21	4701611.36
393	6602593.62	4701619.53
394	6602733.46	4701520.97
395	6602390.54	4701689.14
396	6602450.71	4701754.66
397	6602877.96	4701325.67
398	6602818.97	4701236.63
399	6602693.99	4701553.68
400	6602371.63	4701609.19
401	6602339.45	4701643.37
402	6602570.38	4701646.90
403	6602396.62	4701628.31
404	6602665.59	4701348.81
405	6602656.87	4701355.80
406	6602408.60	4701610.97
407	6602422.51	4701590.85
408	6602456.30	4701748.92
409	6602691.66	4701550.43
410	6602682.18	4701557.11
411	6602581.21	4701416.45
412	6602402.46	4701577.68
413	6602483.99	4701721.10
414	6602407.10	4701799.46

415	6602431.99	4701773.89
416	6602442.48	4701763.12
417	6602542.31	4701671.10
418	6601936.19	4701996.69
419	6602492.42	4701713.86
420	6602403.36	4701618.55
421	6602515.84	4701693.74
422	6602101.62	4701934.89
423	6602390.80	4701636.72
424	6602103.14	4701907.53
425	6602408.31	4701584.13
426	6602551.66	4701442.29
427	6602019.19	4701927.01
428	6602007.69	4701936.42
429	6602384.83	4701671.10
430	6601932.56	4701971.48
431	6601931.68	4701977.69
432	6602176.88	4701936.36
433	6602103.39	4701878.95
434	6602364.50	4701674.77
435	6602328.19	4701733.72
436	6602476.71	4701727.96
437	6602355.02	4701661.01
438	6601892.91	4702010.60
439	6602303.21	4701964.36
440	6602901.40	4701496.13
441	6601829.29	4701814.37
442	6602170.34	4702107.57
443	6602143.43	4702084.05
444	6602139.79	4701983.61
445	6602298.38	4701782.55
446	6601816.51	4701816.37
447	6601822.13	4701817.99
448	6602271.36	4702009.74
449	6602058.47	4702257.12
450	6601907.69	4702206.23
451	6602201.89	4701907.11
452	6602269.02	4701829.14
453	6602152.39	4701968.62
454	6602355.90	4701687.69
455	6602068.37	4702278.43
456	6602179.03	4702118.02

457	6602320.40	4702096.72
458	6601944.22	4701832.29
459	6602094.32	4702182.06
460	6602149.40	4701907.57
461	6602124.84	4701884.34
462	6602348.05	4702104.73
463	6602336.82	4702095.29
464	6602282.87	4701904.50
465	6602299.84	4701881.48
466	6602193.16	4702027.63
467	6602091.06	4702329.81
468	6603120.58	4701193.20
469	6602106.90	4702198.39
470	6602175.22	4702371.75
471	6602111.50	4702202.26
472	6602097.37	4702220.63
473	6602206.23	4702367.88
474	6602183.60	4702362.47
475	6602135.08	4702314.38
476	6602173.72	4702224.28
477	6602142.28	4702258.30
478	6602317.74	4702037.73
479	6602285.50	4702017.10
480	6602119.84	4702181.57
481	6602128.99	4702182.07
482	6602310.30	4701981.77
483	6602047.55	4702208.84
484	6602074.14	4702236.74
485	6602126.52	4702323.22
486	6602167.01	4702378.77
487	6602178.02	4702391.77
488	6601974.70	4702187.73
489	6602275.44	4702046.44
490	6603174.06	4701075.17
491	6603164.96	4701055.22
492	6603111.82	4701079.46
493	6602190.92	4702139.34
494	6602194.35	4702136.43
495	6603120.83	4701099.32
496	6602940.99	4701124.19
497	6602934.65	4701111.57
498	6602941.31	4701108.94

499	6602923.63	4701132.14
500	6602917.61	4701134.48
501	6602913.63	4701124.08
502	6603108.69	4701097.38
503	6602939.63	4701120.64
504	6602200.73	4702143.66
505	6603102.49	4701083.72
506	6602936.14	4701115.47

507	6602945.01	4701118.57
508	6602436.54	4701570.56
509	6603106.29	4701125.66
510	6603096.05	4701103.15
511	6603118.93	4701119.92
512	6603125.13	4701133.58
513	6603106.11	4701142.21
514	6603103.63	4701136.74

515	6603098.62	4701139.01
516	6603094.91	4701130.82
517	6603091.72	4701132.26
518	6603088.00	4701124.07
519	6603081.74	4701126.91
520	6603069.07	4701098.97
521	6602302.26	4702080.34

KOORDINATE TJEMENA GRANICA URBANISTIČKIH PARCELA VAN REGULACIONIH LINIJA

796	602138.95	4702418.15
797	6602132.05	4702420.34
798	6602119.27	4702398.55
799	6602115.89	4702395.46
800	6602129.26	4702368.77
801	6602104.64	4702340.15
802	6602144.25	4702379.32
803	6602153.45	4702389.20
804	6602164.81	4702403.52
805	6602156.81	4702447.72
806	6602171.04	4702477.45
807	6602155.15	4702450.33
808	6602149.90	4702442.39
809	6602147.11	4702432.17
810	6602144.20	4702425.25
811	6602141.10	4702421.05
812	6602178.90	4702421.28
813	6602221.48	4702099.39
814	6602227.35	4702129.91
815	6602229.68	4702127.51
816	6602239.91	4702116.06
817	6602237.51	4702091.95
818	6602232.76	4702088.75
819	6602276.07	4702126.14
820	6602270.88	4702120.70
821	6602259.67	4702110.35
822	6602255.59	4702132.79
823	6602264.58	4702139.80
824	6602234.25	4702138.41
825	6602250.16	4702156.96
826	6601958.16	4702149.02
827	6601937.60	4702161.66
828	6601957.19	4702136.07
829	6601999.37	4702091.08
830	6602016.65	4702076.11
831	6601997.69	4702055.44
832	6602400.70	4701883.34
833	6601990.36	4702098.87
834	6601985.47	4702093.05

835	6602389.24	4701878.02
836	6601976.64	4702117.95
837	6602389.62	4701894.75
838	6601984.78	4702147.01
839	6601999.39	4702108.96
840	6602007.88	4702118.41
841	6602398.36	4701870.05
842	6601930.01	4701840.70
843	6601905.77	4701856.49
844	6601915.91	4701873.18
845	6601940.75	4701857.00
846	6601919.87	4701825.21
847	6601909.10	4701862.09
848	6601896.63	4701789.54
849	6601874.09	4701803.34
850	6601885.57	4701822.60
851	6601908.93	4701808.43
852	6602383.99	4701875.63
853	6602375.19	4701872.74
854	6602374.04	4701885.04
855	6602384.49	4701891.55
856	6602391.55	4701881.29
857	6601921.33	4701881.57
858	6601926.57	4701889.51
859	6601942.43	4701878.76
860	6601934.88	4701902.10
861	6601959.77	4701885.88
862	6602308.24	4701850.87
863	6601951.37	4701873.13
864	6602291.06	4701874.15
865	6601968.24	4701898.73
866	6602329.40	4701868.15
867	6601974.83	4701908.73
868	6601943.35	4701914.93
869	6601952.37	4701928.57
870	6601982.18	4701938.99
871	6601966.63	4701918.21
872	6601870.76	4702011.89
873	6601929.83	4701954.89

874	6601953.18	4701937.06
875	6601935.46	4701910.23
876	6601912.71	4701925.52
877	6601946.02	4701926.22
878	6601934.97	4701971.64
879	6601903.94	4701977.89
880	6601915.63	4701997.45
881	6601900.86	4701972.97
882	6601888.39	4701980.53
883	6601902.47	4702008.25
884	6601898.93	4702000.88
885	6601868.27	4701947.50
886	6601878.87	4701937.89
887	6601851.76	4701956.66
888	6601885.16	4701974.67
889	6601929.52	4701962.30
890	6601918.48	4701943.36
891	6601892.58	4701959.14
892	6601880.89	4701940.23
893	6601886.18	4701948.86
894	6601907.82	4701925.07
895	6601915.11	4701879.36
896	6601906.53	4701884.50
897	6601925.84	4701916.70
898	6601923.14	4701943.42
899	6601893.60	4701843.90
900	6601870.35	4701859.13
901	6601865.80	4701838.42
902	6601860.00	4701841.43
903	6601868.73	4701856.38
904	6601870.74	4701805.53
905	6601864.68	4701809.30
906	6601859.61	4701812.46
907	6601847.75	4701820.26
908	6601883.81	4701827.47
909	6601849.11	4701806.26
910	6601838.59	4701804.54
911	6601837.01	4701801.88
912	6601844.28	4701797.83

913	6601841.96	4701810.04
914	6601856.38	4701835.40
915	6601844.30	4701843.33
916	6601856.23	4701863.24
917	6601869.25	4701884.98
918	6601891.58	4701893.47
919	6601880.62	4701911.86
920	6601868.84	4701921.76
921	6601896.35	4701906.64
922	6601888.15	4701888.64
923	6601881.62	4701877.68
924	6601872.52	4701897.41
925	6601870.55	4701924.60
926	6601855.29	4701933.28
927	6601842.32	4701940.67
928	6601866.68	4701944.95
929	6601834.14	4701926.85
930	6601850.71	4701917.06
931	6601859.20	4701931.06
932	6601849.62	4701889.38
933	6601837.91	4701904.83
934	6601842.95	4701913.93
935	6601844.43	4701916.97
936	6601859.10	4701905.01
937	6601821.36	4701905.21
938	6601837.17	4701878.34
939	6601817.69	4701889.96
940	6601834.06	4701898.12
941	6601835.29	4701866.01
942	6601840.05	4701876.33
943	6601845.24	4701891.67
944	6601852.67	4701894.49
945	6601832.57	4701861.49
946	6601822.23	4701844.29
947	6601807.03	4701853.22
948	6601800.20	4701857.23
949	6601795.05	4701860.72
950	6601804.79	4701877.18
951	6601849.04	4701859.03
952	6601833.20	4701832.57
953	6601805.99	4701817.21
954	6601819.91	4701840.41

955	6601791.69	4701824.44
956	6601774.35	4701863.13
957	6601765.24	4701844.69
958	6601762.47	4701839.22
959	6601745.11	4701848.00
960	6601731.46	4701854.91
961	6601746.44	4701878.65
962	6601735.69	4701884.41
963	6601720.55	4701860.43
964	6601717.97	4701893.87
965	6601741.38	4701900.29
966	6601772.29	4701933.20
967	6601740.14	4701927.78
968	6601773.72	4701905.70
969	6601727.21	4701908.00
970	6601760.44	4701914.16
971	6601783.25	4701921.19
972	6601804.89	4701888.17
973	6601777.74	4701904.59
974	6601824.74	4701921.74
975	6601814.72	4701904.79
976	6601787.80	4701920.97
977	6601798.37	4701938.15
978	6601814.86	4701936.22
979	6601811.60	4701929.94
980	6601803.89	4701934.66
981	6601808.29	4701954.30
982	6601820.37	4701944.87
983	6601834.50	4701938.27
984	6601843.97	4701954.29
985	6601833.78	4701960.70
986	6601818.08	4701970.21
987	6601849.76	4701986.84
988	6601859.51	4701980.57
989	6601851.92	4701967.73
990	6601826.19	4701983.42
991	6601872.72	4702006.20
992	6601834.45	4701996.84
993	6601874.37	4702009.72
994	6601867.22	4701994.14
995	6601862.06	4701997.47
996	6601856.95	4702000.92

997	6601842.57	4702010.06
998	6601851.23	4702024.14
999	6601868.04	4702013.77
1000	6601820.08	4702019.08
1001	6601836.53	4702007.86
1002	6601817.46	4702000.54
1003	6601806.06	4702028.58
1004	6601812.23	4702024.22
1005	6601817.99	4701977.70
1006	6601788.24	4702001.33
1007	6601796.69	4702014.26
1008	6601811.43	4701967.04
1009	6601784.11	4701987.35
1010	6601827.94	4701993.89
1011	6601780.73	4701989.84
1012	6601799.86	4701960.17
1013	6601804.86	4701956.34
1014	6601796.87	4701943.36
1015	6601765.97	4701967.27
1016	6601774.17	4701979.82
1017	6602168.46	4702092.18
1018	6602190.90	4702088.69
1019	6602198.64	4702096.15
1020	6602213.21	4702072.77
1021	6602223.94	4702063.99
1022	6602034.87	4702050.33
1023	6602129.26	4701983.70
1024	6602132.99	4702027.65
1025	6602119.37	4702017.14
1026	6602108.26	4702008.71
1027	6602057.53	4702032.19
1028	6602067.27	4702043.50
1029	6602043.31	4702072.02
1030	6602031.58	4702052.62
1031	6602053.63	4702002.95
1032	6602013.89	4701958.47
1033	6602004.43	4701966.52
1034	6602030.82	4701978.22
1035	6601991.97	4701951.33
1036	6601987.68	4701946.11
1037	6601986.30	4701991.79
1038	6601969.21	4701961.80

1039	6601958.07	4701996.99
1040	6601984.38	4702032.32
1041	6602010.33	4702017.48
1042	6601963.30	4702004.10
1043	6601995.49	4701998.69
1044	6601999.22	4702023.91
1045	6601998.95	4702048.67
1046	6602012.26	4702040.87
1047	6602021.29	4702035.60
1048	6602048.83	4702021.17
1049	6602025.77	4702035.28
1050	6602028.80	4701996.29
1051	6602020.21	4702026.08
1052	6602020.51	4701986.12
1053	6602010.56	4702010.12
1054	6601945.49	4702119.18
1055	6601968.65	4702125.85
1056	6601974.49	4702079.36
1057	6601957.47	4702086.08
1058	6601968.74	4702104.81
1059	6601962.60	4702094.61
1060	6601952.80	4702100.63
1061	6601943.56	4702106.31
1062	6601932.70	4702101.05
1063	6601938.53	4702109.31
1064	6601946.68	4702104.25
1065	6601945.99	4702067.37
1066	6601919.41	4702082.22
1067	6601933.88	4702047.98
1068	6601912.68	4702011.60
1069	6601922.40	4702028.38
1070	6601923.84	4702011.14
1071	6601920.20	4702005.38
1072	6601915.17	4702015.65
1073	6601981.35	4702037.29
1074	6601957.52	4702058.26
1075	6601970.75	4702023.51
1076	6601958.55	4702006.92
1077	6601945.88	4702041.99
1078	6601952.74	4702078.11
1079	6601967.22	4702070.25
1080	6601962.90	4702064.90

1081	6601925.02	4702143.65
1082	6601897.04	4702152.00
1083	6601961.96	4702157.47
1084	6601946.93	4702130.75
1085	6601892.05	4702181.13
1086	6601900.16	4702199.00
1087	6601919.70	4702187.60
1088	6601909.01	4702171.21
1089	6601921.30	4702164.12
1090	6601932.29	4702154.22
1091	6601952.89	4702181.64
1092	6601920.67	4702138.14
1093	6601893.48	4702097.45
1094	6601888.10	4702089.69
1095	6601854.19	4702074.39
1096	6601861.35	4702047.99
1097	6601865.07	4702053.75
1098	6601867.61	4702057.08
1099	6601871.43	4702063.76
1100	6601882.52	4702080.56
1101	6601881.83	4702083.92
1102	6601876.62	4702071.50
1103	6601856.77	4702079.75
1104	6601842.51	4702086.63
1105	6601865.40	4702094.00
1106	6601851.78	4702102.73
1107	6601855.69	4702109.70
1108	6601913.93	4702083.99
1109	6602010.45	4702372.58
1110	6602073.29	4702352.40
1111	6602013.22	4702370.92
1112	6602034.65	4702357.03
1113	6602049.68	4702381.74
1114	6602059.22	4702331.58
1115	6602083.93	4702314.80
1116	6602081.29	4702311.57
1117	6602060.33	4702285.97
1118	6602039.25	4702300.45
1119	6602057.08	4702328.21
1120	6602074.68	4702316.19
1121	6602018.11	4702315.00
1122	6602003.15	4702310.29

1123	6602019.89	4702331.23
1124	6602000.94	4702344.39
1125	6602033.49	4702354.08
1126	6602040.50	4702349.66
1127	6602038.18	4702346.06
1128	6602007.78	4702317.48
1129	6602000.53	4702322.59
1130	6601983.39	4702295.08
1131	6601972.35	4702302.38
1132	6601986.20	4702333.01
1133	6601967.18	4702305.97
1134	6602037.12	4702257.63
1135	6602024.72	4702242.50
1136	6602016.33	4702248.11
1137	6602020.42	4702271.21
1138	6602010.44	4702225.06
1139	6601985.49	4702240.90
1140	6601948.07	4702199.16
1141	6601921.45	4702222.34
1142	6601944.37	4702238.70
1143	6601927.25	4702218.33
1144	6601925.70	4702252.60
1145	6602009.10	4702278.55
1146	6601978.41	4702274.35
1147	6601950.13	4702234.72
1148	6601981.30	4702244.25
1149	6601964.47	4702254.44
1150	6601943.22	4702275.75
1151	6601949.08	4702271.49
1152	6601960.53	4702263.36
1153	6602004.62	4702173.80
1154	6601986.93	4702158.29
1155	6602008.73	4702191.09
1156	6602017.83	4702182.97
1157	6602032.19	4702168.80
1158	6601999.20	4702200.28
1159	6602010.89	4702214.56
1160	6602016.92	4702208.99
1161	6602538.80	4701745.03
1162	6602061.39	4702192.75
1163	6602041.16	4702207.91
1164	6601999.94	4702142.95

1165	6602021.53	4702160.07
1166	6602103.33	4702144.51
1167	6602144.41	4702141.76
1168	6602134.79	4702132.39
1169	6602113.27	4702153.47
1170	6602066.38	4702058.56
1171	6602071.51	4702083.85
1172	6602404.59	4701567.07
1173	6602543.20	4701724.26
1174	6602523.12	4701702.00
1175	6602088.85	4702097.19
1176	6602160.31	4702030.62
1177	6602412.17	4701567.55
1178	6602127.84	4702085.61
1179	6602114.46	4702076.19
1180	6602105.32	4702086.97
1181	6602093.61	4702100.77
1182	6602106.60	4702110.53
1183	6602179.04	4702061.17
1184	6602151.09	4702111.10
1185	6602302.91	4702196.10
1186	6602150.08	4702129.67
1187	6602143.54	4702116.81
1188	6602129.63	4702127.35
1189	6602165.22	4702117.43
1190	6602148.30	4702146.27
1191	6602143.59	4702263.23
1192	6602125.89	4702253.65
1193	6602097.48	4702292.65
1194	6602571.01	4701732.82
1195	6602565.37	4701728.38
1196	6602399.93	4701599.73
1197	6602575.96	4701736.72
1198	6602149.54	4702255.72
1199	6602154.81	4702249.94
1200	6602137.52	4702236.22
1201	6602576.89	4701703.52
1202	6602126.74	4702228.17
1203	6602113.37	4702232.35
1204	6602126.93	4702241.44
1205	6602556.82	4701721.64
1206	6602274.60	4702155.87

1207	6602151.06	4702234.64
1208	6602449.69	4701522.07
1209	6602169.65	4702214.94
1210	6602164.65	4702065.17
1211	6602158.59	4702060.80
1212	6602582.63	4701708.05
1213	6602206.96	4702199.80
1214	6602290.58	4702144.72
1215	6602173.94	4702210.39
1216	6602452.56	4701528.79
1217	6602182.16	4702047.85
1218	6602545.57	4701722.41
1219	6602162.56	4702162.44
1220	6602153.93	4702152.35
1221	6602185.15	4702065.61
1222	6602539.84	4701716.05
1223	6602409.03	4701562.64
1224	6602194.53	4702167.78
1225	6602159.23	4702101.50
1226	6602154.42	4702025.94
1227	6602142.91	4702050.97
1228	6602392.93	4701822.26
1229	6602136.08	4702030.04
1230	6602153.26	4702042.19
1231	6602530.14	4701734.42
1232	6602634.52	4701881.43
1233	6602185.67	4702158.95
1234	6602562.59	4701709.16
1235	6602200.05	4702045.02
1236	6602542.93	4701684.98
1237	6602525.39	4701700.04
1238	6602181.14	4702079.37
1239	6602070.61	4701979.14
1240	6602085.67	4701965.37
1241	6602090.60	4701970.41
1242	6602079.28	4701958.83
1243	6602201.52	4702080.67
1244	6602080.30	4701994.63
1245	6602170.66	4702070.20
1246	6602090.21	4702005.14
1247	6602095.19	4702010.28
1248	6602388.92	4701827.30

1249	6602190.36	4702037.58
1250	6602212.61	4702054.86
1251	6602124.66	4702038.93
1252	6602097.73	4702007.25
1253	6602555.58	4701695.78
1254	6602124.90	4701974.91
1255	6602421.73	4701566.65
1256	6602094.69	4701974.70
1257	6602132.94	4702044.54
1258	6602472.43	4701806.49
1259	6603051.53	4701131.65
1260	6602108.37	4702048.04
1261	6602062.47	4701974.76
1262	6602019.78	4701956.91
1263	6602192.25	4702071.65
1264	6602247.63	4702264.61
1265	6602238.39	4702276.51
1266	6602194.82	4702057.71
1267	6602204.21	4702065.44
1268	6602384.31	4701823.70
1269	6602388.54	4701818.06
1270	6602159.50	4702012.54
1271	6602150.50	4702022.63
1272	6602114.69	4702052.42
1273	6602185.77	4702109.83
1274	6602190.36	4702114.47
1275	6602172.20	4702055.31
1276	6602166.68	4702051.62
1277	6602438.58	4701543.77
1278	6602040.59	4701950.72
1279	6603068.23	4701158.51
1280	6602040.13	4701915.45
1281	6602535.62	4701741.74
1282	6602549.04	4701687.93
1283	6602355.00	4702440.00
1284	6602141.36	4702070.89
1285	6602128.31	4702061.87
1286	6602166.15	4702089.82
1287	6602073.96	4701917.92
1288	6602261.83	4702246.32
1289	6602143.09	4702016.70
1290	6602857.16	4701237.96

1291	6602078.37	4701917.64
1292	6602204.89	4702103.49
1293	6602104.23	4701950.04
1294	6602108.88	4701945.23
1295	6602558.05	4701693.73
1296	6602586.19	4701710.43
1297	6603077.03	4701178.60
1298	6602518.21	4701718.87
1299	6603050.83	4701149.17
1300	6602532.30	4701737.42
1301	6602526.99	4701741.55
1302	6602523.89	4701742.41
1303	6603169.13	4701150.84
1304	6602521.04	4701744.57
1305	6603113.85	4701199.51
1306	6602523.59	4701748.89
1307	6603090.01	4701200.72
1308	6603086.32	4701192.53
1309	6602173.68	4702004.62
1310	6602163.50	4702015.73
1311	6603088.20	4701108.02
1312	6603122.01	4701195.64
1313	6603139.72	4701187.25
1314	6603054.49	4701147.86
1315	6602486.46	4701733.93
1316	6602472.56	4701747.99
1317	6602478.59	4701754.40
1318	6602964.04	4701333.15
1319	6603233.31	4701135.56
1320	6603103.12	4701173.10
1321	6603167.01	4701146.20
1322	6602509.38	4701756.89
1323	6602195.61	4702041.58
1324	6603106.26	4701203.11
1325	6603104.69	4701199.68
1326	6603100.34	4701189.46
1327	6602493.89	4701757.63
1328	6602207.19	4702452.73
1329	6602971.99	4701276.72
1330	6602942.20	4701298.73
1331	6602153.40	4702079.43
1332	6603060.07	4701145.27

1333	6603183.54	4701129.16
1334	6603092.42	4701169.80
1335	6603091.28	4701167.01
1336	6601851.48	4702032.02
1337	6603072.60	4701168.57
1338	6603094.90	4701175.79
1339	6603150.50	4701159.61
1340	6602989.58	4701330.46
1341	6602987.32	4701328.30
1342	6603231.59	4701132.10
1343	6603225.37	4701118.45
1344	6602190.42	4702008.83
1345	6602971.45	4701340.26
1346	6602956.59	4701317.28
1347	6603148.08	4701155.20
1348	6603104.89	4701108.93
1349	6603101.73	4701102.63
1350	6602964.83	4701324.55
1351	6602430.00	4702155.00
1352	6602504.93	4701543.15
1353	6603194.90	4701152.45
1354	6603211.15	4701145.99
1355	6601841.24	4702015.54
1356	6603064.22	4701146.28
1357	6603099.21	4701186.61
1358	6603207.12	4701121.88
1359	6603046.19	4701151.91
1360	6602122.34	4702355.24
1361	6602966.98	4701306.61
1362	6602970.88	4701312.77
1363	6602447.78	4701571.03
1364	6603062.54	4701105.55
1365	6603068.83	4701102.70
1366	6603066.38	4701097.25
1367	6603000.46	4701341.50
1368	6602086.26	4702135.40
1369	6602197.72	4702427.90
1370	6602105.77	4702227.95
1371	6603114.30	4701177.55
1372	6603187.34	4701137.58
1373	6603188.77	4701140.30
1374	6602093.87	4702202.87

1375	6603094.12	4701208.86
1376	6602077.31	4702295.66
1377	6602082.72	4702291.22
1378	6602489.52	4701555.13
1379	6602975.61	4701309.37
1380	6603052.38	4701165.93
1381	6603117.21	4701135.91
1382	6603111.67	4701123.72
1383	6603030.16	4701130.09
1384	6602146.08	4702328.17
1385	6602864.60	4701238.68
1386	6602093.96	4702141.46
1387	6602935.82	4701313.44
1388	6602994.46	4701314.27
1389	6602291.15	4702078.57
1390	6602296.66	4702079.32
1391	6602098.54	4702221.75
1392	6602963.57	4701301.80
1393	6602106.82	4702241.63
1394	6601856.54	4702040.38
1395	6602256.44	4702099.99
1396	6602877.50	4701260.06
1397	6602275.21	4702046.66
1398	6602464.14	4701594.94
1399	6602090.67	4702215.40
1400	6602081.64	4702300.95
1401	6602954.86	4701289.37
1402	6602110.91	4702278.66
1403	6603172.99	4701158.76
1404	6602253.22	4702102.53
1405	6602040.45	4702250.66
1406	6601835.46	4702019.48
1407	6601830.74	4702011.81
1408	6602104.38	4702213.00
1409	6602086.55	4702295.89
1410	6602105.11	4701917.49
1411	6602210.19	4702110.07
1412	6602495.30	4701690.63
1413	6602946.46	4701304.47
1414	6602089.15	4702208.97
1415	6602092.76	4702298.67
1416	6602984.50	4701312.30

1417	6602263.30	4702091.82
1418	6602268.47	4702095.82
1419	6602044.61	4702212.26
1420	6602760.38	4701303.45
1421	6602086.46	4702228.51
1422	6602949.42	4701308.63
1423	6602773.99	4701293.38
1424	6602050.61	4702155.66
1425	6602123.79	4702212.62
1426	6602107.61	4702215.14
1427	6602115.66	4702220.94
1428	6602246.10	4702097.78
1429	6603216.92	4701143.28
1430	6602264.23	4702043.56
1431	6602302.26	4702080.34
1432	6602979.47	4701353.87
1433	6603201.39	4701124.51
1434	6602225.22	4702127.52
1435	6602081.59	4702211.45
1436	6602917.91	4701369.95
1437	6602910.25	4701377.12
1438	6602102.35	4702224.90
1439	6602290.09	4702120.33
1440	6602286.77	4702073.99
1441	6602939.30	4701371.85
1442	6602944.96	4701379.21
1443	6602075.43	4702250.67
1444	6602090.81	4702232.71
1445	6602288.38	4702110.44
1446	6602282.94	4702106.39
1447	6602911.56	4701350.23
1448	6602932.95	4701365.78
1449	6602836.00	4701530.65
1450	6602097.81	4702190.53
1451	6602105.29	4702196.86
1452	6602269.52	4702083.78
1453	6602092.59	4702191.31
1454	6602487.66	4701681.87
1455	6602484.21	4701678.03
1456	6602774.55	4701259.13
1457	6602280.18	4702104.51
1458	6602810.05	4701289.05

1459	6602097.37	4702206.14
1460	6602246.92	4702081.08
1461	6602257.72	4702088.49
1462	6602832.83	4701526.05
1463	6602818.66	4701305.31
1464	6602301.41	4702053.61
1465	6602295.48	4702061.87
1466	6602802.24	4701298.17
1467	6602057.56	4702271.54
1468	6602494.34	4701717.48
1469	6602213.60	4702164.15
1470	6602948.46	4701381.83
1471	6602714.92	4701396.64
1472	6602809.85	4701502.13
1473	6602728.54	4701414.93
1474	6602768.20	4701319.15
1475	6602783.13	4701306.61
1476	6602244.71	4702151.03
1477	6602903.37	4701353.82
1478	6602265.89	4702059.96
1479	6602221.38	4702123.00
1480	6602218.03	4702119.23
1481	6602956.67	4701371.73
1482	6602179.81	4701870.02
1483	6602418.95	4701627.91
1484	6602807.01	4701284.68
1485	6602788.80	4701279.60
1486	6602031.10	4702195.50
1487	6602990.05	4701313.67
1488	6602815.32	4701296.08
1489	6602884.59	4701216.38
1490	6602259.70	4702096.72
1491	6602755.07	4701395.04
1492	6602936.00	4701367.63
1493	6602910.80	4701390.70
1494	6602164.64	4701854.81
1495	6602137.24	4701891.21
1496	6602734.63	4701396.26
1497	6602975.30	4701336.19
1498	6602180.55	4701790.64
1499	6602820.73	4701521.22
1500	6602798.43	4701272.06

1501	6602792.89	4701276.41
1502	6602312.59	4702071.76
1503	6602960.71	4701320.92
1504	6602845.58	4701246.43
1505	6602145.95	4701999.90
1506	6602822.74	4701503.92
1507	6602089.48	4702198.49
1508	6602026.32	4702233.41
1509	6602888.23	4701213.87
1510	6602102.51	4702243.99
1511	6602036.76	4702172.36
1512	6602908.66	4701238.17
1513	6602149.67	4702003.51
1514	6602827.69	4701515.84
1515	6602921.05	4701366.92
1516	6602498.95	4701713.54
1517	6602833.18	4701543.35
1518	6602193.39	4701857.13
1519	6602200.44	4701864.09
1520	6602146.13	4701899.05
1521	6602832.46	4701500.77
1522	6602242.24	4702077.88
1523	6602890.06	4701280.57
1524	6602940.17	4701362.96
1525	6602772.10	4701319.34
1526	6602183.04	4701866.85
1527	6602543.54	4701505.68
1528	6602570.72	4701482.00
1529	6602758.23	4701271.04
1530	6602156.56	4701874.54
1531	6602170.44	4701860.45
1532	6602192.27	4701820.00
1533	6602238.26	4701801.19
1534	6602847.80	4701357.90
1535	6602836.97	4701271.45
1536	6602810.39	4701485.10
1537	6602269.14	4702053.92
1538	6602209.78	4701778.21
1539	6602842.97	4701338.22
1540	6602841.00	4701335.77
1541	6602237.83	4702142.73
1542	6602527.63	4701452.52

1543	6602201.62	4701808.90
1544	6602165.26	4701813.08
1545	6602181.16	4701828.04
1546	6602825.22	4701510.73
1547	6602816.19	4701492.98
1548	6602218.96	4701824.89
1549	6602739.55	4701392.16
1550	6602193.54	4701845.64
1551	6602174.60	4701864.70
1552	6602190.04	4702292.57
1553	6602207.00	4701775.49
1554	6602748.88	4701331.27
1555	6602148.09	4701838.71
1556	6602721.72	4701405.77
1557	6602485.02	4701698.62
1558	6602428.34	4701617.50
1559	6603014.33	4701296.94
1560	6602879.29	4701263.16
1561	6602785.18	4701309.49
1562	6602750.51	4701333.82
1563	6602855.90	4701351.91
1564	6602789.68	4701361.22
1565	6602162.14	4701810.00
1566	6602746.69	4701401.20
1567	6602184.35	4701792.39
1568	6603029.71	4701308.84
1569	6602834.30	4701506.54
1570	6602285.46	4702054.15
1571	6602738.31	4701342.67
1572	6602888.92	4701205.69
1573	6602820.27	4701497.62
1574	6602213.97	4701820.59
1575	6602845.35	4701284.35
1576	6603018.73	4701300.04
1577	6602802.89	4701317.08
1578	6602745.11	4701314.58
1579	6603034.47	4701304.43
1580	6603039.68	4701312.07
1581	6602215.56	4701783.31
1582	6602815.22	4701307.73
1583	6602811.17	4701311.28
1584	6602830.74	4701521.08

1585	6602391.06	4701612.53
1586	6602379.51	4701600.81
1587	6602783.94	4701405.07
1588	6602794.16	4701397.52
1589	6602893.61	4701250.81
1590	6602829.90	4701338.25
1591	6603008.21	4701296.34
1592	6602171.32	4701799.86
1593	6602174.80	4701803.21
1594	6602819.64	4701323.37
1595	6602827.16	4701334.27
1596	6602823.85	4701333.94
1597	6602838.16	4701326.58
1598	6602204.93	4701832.17
1599	6602183.60	4701830.29
1600	6602280.21	4702132.10
1601	6602863.55	4701346.26
1602	6601989.42	4702290.17
1603	6602001.14	4702307.60
1604	6602778.84	4701285.41
1605	6602764.66	4701266.35
1606	6602896.59	4701276.87
1607	6602903.00	4701273.24
1608	6602542.57	4701472.60
1609	6602767.53	4701383.22
1610	6603030.09	4701318.24
1611	6602905.70	4701271.71
1612	6602902.66	4701266.60
1613	6602731.08	4701332.83
1614	6602833.02	4701346.68
1615	6602798.68	4701293.35
1616	6602175.74	4702310.22
1617	6602139.92	4702282.35
1618	6602836.94	4701514.51
1619	6602984.92	4701150.08
1620	6602728.97	4701329.82
1621	6602896.15	4701255.05
1622	6602371.63	4701609.19
1623	6602316.02	4701889.59
1624	6602367.74	4701953.92
1625	6602385.42	4701586.20
1626	6602015.94	4702311.63

1627	6602282.06	4702221.30
1628	6602264.57	4701889.81
1629	6602844.85	4701359.04
1630	6602056.12	4702288.85
1631	6602845.87	4701547.26
1632	6602830.63	4701334.90
1633	6602366.65	4701604.93
1634	6602294.82	4702031.54
1635	6602288.46	4702028.31
1636	6602374.93	4701960.22
1637	6602370.26	4701955.75
1638	6602972.25	4701142.70
1639	6602725.12	4701402.90
1640	6603033.74	4701315.89
1641	6602721.19	4701318.69
1642	6603007.43	4701291.60
1643	6602770.10	4701386.75
1644	6602281.69	4701938.60
1645	6602852.23	4701346.68
1646	6602301.29	4701953.01
1647	6602325.67	4701895.56
1648	6602360.34	4701955.95
1649	6603137.56	4701089.69
1650	6602754.53	4701307.70
1651	6601755.20	4701893.25
1652	6602346.72	4701944.44
1653	6602755.91	4701353.56
1654	6602377.63	4701967.08
1655	6602227.98	4702193.74
1656	6602348.06	4701909.36
1657	6602338.85	4701938.03
1658	6602982.00	4701179.19
1659	6602985.29	4701177.77
1660	6602992.88	4701165.24
1661	6603003.15	4701184.80
1662	6602009.74	4702302.04
1663	6602031.73	4702262.43
1664	6602749.30	4701311.68
1665	6602264.46	4701925.92
1666	6602810.07	4701343.01
1667	6602985.75	4701200.03
1668	6602270.28	4702179.45

1669	6602965.88	4701164.75
1670	6602265.05	4702196.34
1671	6601907.72	4702118.70
1672	6602360.53	4701621.00
1673	6602299.53	4702034.56
1674	6602272.01	4702050.03
1675	6602795.94	4701356.08
1676	6602264.87	4702150.34
1677	6602383.05	4701672.75
1678	6601882.31	4702160.68
1679	6602362.49	4701985.71
1680	6602363.83	4701950.95
1681	6602369.76	4701942.44
1682	6601901.19	4702108.78
1683	6602969.92	4701149.44
1684	6602746.65	4701328.49
1685	6601786.33	4701856.77
1686	6602343.16	4701940.83
1687	6601872.36	4702140.86
1688	6602846.42	4701342.67
1689	6602385.27	4701620.88
1690	6603093.83	4701086.33
1691	6602372.95	4701962.51
1692	6602375.29	4701665.58
1693	6602026.62	4702266.99
1694	6601863.58	4702124.15
1695	6602287.69	4701879.93
1696	6603118.54	4701140.51
1697	6602188.54	4702426.80
1698	6602846.10	4701208.22
1699	6601792.52	4701867.23
1700	6602388.46	4701954.68
1701	6601757.04	4701872.46
1702	6601933.59	4702111.86
1703	6601925.58	4702100.51
1704	6602400.06	4701690.63
1705	6602194.99	4702360.55
1706	6602829.69	4701278.69
1707	6601779.08	4701860.65
1708	6601766.86	4701867.13
1709	6602394.91	4701685.02
1710	6602121.32	4702120.49

1711	6602974.14	4701158.35
1712	6602980.30	4701163.68
1713	6602771.78	4701290.24
1714	6602366.57	4701657.52
1715	6602961.71	4701159.12
1716	6603117.92	4701113.46
1717	6601934.30	4702025.69
1718	6602184.29	4702362.94
1719	6602233.33	4702200.44
1720	6602243.28	4702209.17
1721	6602287.35	4702214.90
1722	6602271.49	4702192.79
1723	6601885.69	4702132.10
1724	6602247.17	4702214.21
1725	6601887.95	4702157.37
1726	6601897.61	4702103.42
1727	6602997.53	4701194.84
1728	6602716.56	4701362.54
1729	6602788.12	4701500.79
1730	6602823.43	4701254.93
1731	6602258.34	4702158.10
1732	6602246.65	4702172.01
1733	6602265.33	4702182.43
1734	6602102.82	4702115.69
1735	6602555.85	4701461.61
1736	6602166.87	4702406.12
1737	6602090.22	4702130.51
1738	6601892.08	4702128.13
1739	6602796.69	4701536.24
1740	6602037.49	4702093.45
1741	6602066.29	4702115.43
1742	6602315.43	4701927.84
1743	6602411.45	4701682.29
1744	6602685.82	4701327.10
1745	6602694.87	4701340.50
1746	6602597.21	4701518.31
1747	6602835.98	4701274.39
1748	6602830.19	4701265.42
1749	6602267.81	4701870.11
1750	6602194.52	4702418.59
1751	6602218.38	4701878.61
1752	6602211.95	4702090.44

1753	6602394.19	4701662.43
1754	6601904.74	4702114.08
1755	6602083.04	4702092.82
1756	6602252.44	4702219.08
1757	6602388.28	4701667.90
1758	6601910.96	4702123.72
1759	6602962.61	4701263.64
1760	6602584.02	4701500.23
1761	6602556.09	4701523.24
1762	6602697.60	4701315.28
1763	6602187.93	4702360.22
1764	6602806.36	4701527.33
1765	6602913.64	4701217.84
1766	6602712.19	4701335.23
1767	6602714.85	4701338.74
1768	6603109.82	4701119.46
1769	6602277.63	4701850.81
1770	6602985.53	4701172.40
1771	6602220.52	4702061.24
1772	6602709.90	4701332.34
1773	6602380.61	4701699.06
1774	6602804.33	4701268.21
1775	6602705.16	4701370.66
1776	6602557.89	4701493.18
1777	6602814.52	4701276.27
1778	6602447.69	4701773.53
1779	6603132.81	4701080.23
1780	6601767.05	4701887.21
1781	6602801.43	4701521.01
1782	6602753.35	4701337.58
1783	6602280.25	4701852.62
1784	6602073.34	4702106.13
1785	6602179.71	4702385.17
1786	6602701.00	4701348.94
1787	6602876.25	4701185.65
1788	6602883.67	4701197.49
1789	6602824.68	4701290.90
1790	6602670.24	4701335.24
1791	6602802.63	4701238.65
1792	6602080.27	4702129.86
1793	6602055.56	4702071.44
1794	6602861.30	4701271.85

1795	6602711.43	4701369.92
1796	6602843.01	4701316.75
1797	6602687.16	4701359.36
1798	6602761.86	4701348.87
1799	6602776.03	4701367.63
1800	6602698.57	4701350.73
1801	6602777.33	4701257.11
1802	6602704.59	4701346.29
1803	6602862.29	4701234.85
1804	6602693.30	4701354.37
1805	6601928.77	4702006.94
1806	6602822.50	4701283.61
1807	6602809.54	4701264.42
1808	6602749.75	4701358.18
1809	6602816.73	4701259.51
1810	6602977.40	4701153.53
1811	6602794.65	4701322.91
1812	6602736.04	4701339.62
1813	6602761.62	4701375.50
1814	6602837.68	4701290.49
1815	6602833.48	4701293.82
1816	6602726.28	4701325.93
1817	6602177.94	4702361.02
1818	6602787.12	4701510.06
1819	6602918.11	4701185.47
1820	6602929.98	4701206.38
1821	6602364.16	4701958.90
1822	6602936.10	4701282.98
1823	6602783.79	4701339.59
1824	6602779.55	4701334.23
1825	6602892.75	4701284.92
1826	6602244.67	4701895.19
1827	6602787.61	4701540.58
1828	6602936.51	4701250.06
1829	6602901.58	4701226.26
1830	6602817.34	4701299.87
1831	6602821.24	4701302.94
1832	6602658.04	4701463.30
1833	6602783.95	4701330.79
1834	6602783.21	4701504.25
1835	6602807.93	4701345.13
1836	6602953.20	4701270.16

1837	6602792.01	4701506.62
1838	6602778.15	4701370.46
1839	6602724.88	4701352.16
1840	6602728.76	4701357.34
1841	6602216.48	4702086.47
1842	6602568.09	4701540.05
1843	6602728.75	4701382.16
1844	6602829.29	4701297.16
1845	6602806.79	4701531.22
1846	6602191.24	4702424.26
1847	6602189.41	4702420.75
1848	6602911.84	4701189.73
1849	6602926.91	4701236.72
1850	6602941.57	4701226.75
1851	6602684.39	4701540.24
1852	6602639.83	4701476.83
1853	6602652.36	4701467.78
1854	6602921.97	4701259.92
1855	6602715.69	4701454.33
1856	6602708.98	4701306.97
1857	6602907.51	4701313.78
1858	6602706.40	4701527.25
1859	6602892.24	4701211.18
1860	6602747.09	4701408.51
1861	6602744.42	4701404.89
1862	6602841.52	4701287.42
1863	6602943.97	4701245.20
1864	6602895.26	4701293.45
1865	6602916.39	4701215.92
1866	6602736.48	4701367.82
1867	6602181.76	4702392.93
1868	6602953.81	4701248.24
1869	6602947.90	4701277.59
1870	6602950.89	4701281.71
1871	6602801.36	4701276.25
1872	6602874.22	4701291.27
1873	6602875.71	4701294.99
1874	6602035.36	4702096.22
1875	6602064.18	4702118.22
1876	6602769.93	4701415.42
1877	6602933.88	4701252.14
1878	6602719.40	4701370.01

1879	6602233.69	4702072.03
1880	6602228.58	4702067.95
1881	6602957.98	4701266.67
1882	6602714.43	4701539.17
1883	6602287.36	4701836.73
1884	6602711.26	4701482.91
1885	6602714.24	4701480.59
1886	6602748.30	4701384.87
1887	6602672.47	4701476.52
1888	6602673.94	4701485.20
1889	6602688.15	4701416.21
1890	6602755.95	4701391.90
1891	6602730.57	4701384.55
1892	6602674.77	4701479.66
1893	6602663.34	4701463.82
1894	6602639.37	4701391.33
1895	6602664.78	4701511.67
1896	6602661.24	4701506.68
1897	6602670.93	4701433.89
1898	6602947.39	4701262.31
1899	6602646.38	4701447.08
1900	6602634.11	4701456.94
1901	6602659.79	4701376.94
1902	6602096.89	4702122.74
1903	6602949.83	4701241.26
1904	6602696.38	4701535.22
1905	6602767.18	4701478.55
1906	6602624.43	4701370.61
1907	6602700.91	4701377.82
1908	6602725.94	4701536.05
1909	6602721.80	4701529.09
1910	6602678.64	4701532.14
1911	6602618.76	4701408.67
1912	6602605.47	4701390.20
1913	6602755.33	4701492.94
1914	6602612.23	4701466.53
1915	6602732.35	4701346.54
1916	6602815.49	4701381.76
1917	6602686.44	4701543.11
1918	6602894.82	4701323.16
1919	6602671.59	4701499.50
1920	6602683.71	4701451.88

1921	6602704.04	4701438.20
1922	6602664.50	4701490.03
1923	6602827.57	4701372.84
1924	6602913.55	4701245.90
1925	6602651.64	4701447.55
1926	6602604.93	4701528.89
1927	6602575.33	4701550.19
1928	6602818.79	4701389.89
1929	6602722.11	4701474.80
1930	6602601.87	4701452.08
1931	6602727.39	4701470.53
1932	6602835.20	4701457.32
1933	6602658.96	4701503.50
1934	6602650.01	4701490.83
1935	6602699.12	4701375.42
1936	6602942.76	4701262.52
1937	6602805.60	4701445.51
1938	6602674.28	4701390.16
1939	6602690.87	4701378.52
1940	6602702.11	4701428.70
1941	6602716.84	4701542.47
1942	6602712.96	4701443.72
1943	6602696.31	4701556.94
1944	6602720.26	4701415.53
1945	6602737.56	4701477.78
1946	6602668.40	4701477.71
1947	6602672.73	4701394.85
1948	6602709.37	4701400.91
1949	6602751.10	4701417.32
1950	6602756.90	4701425.04
1951	6602631.78	4701465.98
1952	6602628.81	4701460.94
1953	6602604.79	4701427.57
1954	6602682.89	4701496.85
1955	6602627.62	4701487.96
1956	6602766.89	4701484.18
1957	6602704.03	4701523.63
1958	6602600.66	4701421.94
1959	6602673.78	4701525.02
1960	6602672.09	4701522.51
1961	6602708.28	4701485.23
1962	6602651.74	4701407.33

1963	6602631.41	4701426.27
1964	6602622.54	4701433.77
1965	6602939.57	4701258.05
1966	6602926.48	4701267.27
1967	6602621.12	4701405.11
1968	6602640.78	4701596.08
1969	6602721.85	4701373.51
1970	6602725.23	4701378.22
1971	6602827.35	4701426.38
1972	6602868.99	4701390.37
1973	6602615.34	4701442.32
1974	6602793.06	4701451.16
1975	6602741.00	4701320.99
1976	6602724.68	4701459.96
1977	6602741.00	4701447.74
1978	6602740.38	4701373.19
1979	6602742.38	4701375.94
1980	6602645.45	4701512.80
1981	6602850.95	4701366.14
1982	6602691.35	4701413.80
1983	6602725.21	4701509.55
1984	6602986.21	4701275.84
1985	6602794.50	4701448.05
1986	6602812.69	4701473.12
1987	6602716.20	4701366.46
1988	6602750.55	4701495.77
1989	6602679.20	4701360.38
1990	6602713.81	4701517.14
1991	6602983.53	4701272.87
1992	6602768.76	4701468.95
1993	6602859.05	4701398.30
1994	6602758.93	4701507.38
1995	6602950.18	4701272.46
1996	6602891.62	4701288.49
1997	6602932.26	4701337.08
1998	6602645.21	4701484.01
1999	6602598.03	4701481.76
2000	6602738.14	4701527.45
2001	6602626.36	4701493.07
2002	6602600.21	4701484.90
2003	6602713.13	4701394.23
2004	6602834.35	4701412.33

2005	6602696.40	4701468.96
2006	6602587.44	4701403.90
2007	6602659.10	4701531.82
2008	6602730.98	4701429.92
2009	6602724.61	4701435.09
2010	6602661.88	4701486.67
2011	6602585.73	4701436.46
2012	6602887.24	4701381.44
2013	6602629.32	4701580.70
2014	6602819.86	4701356.64
2015	6602813.41	4701347.67
2016	6602815.63	4701437.93
2017	6602823.68	4701467.17
2018	6602603.00	4701488.58
2019	6602776.38	4701423.06
2020	6602763.83	4701487.76
2021	6602760.21	4701490.05
2022	6602756.30	4701463.94
2023	6602832.24	4701427.29
2024	6602849.52	4701401.16
2025	6602597.63	4701512.09
2026	6602662.06	4701373.24
2027	6602871.91	4701394.25
2028	6602882.26	4701407.73
2029	6602798.17	4701485.15
2030	6602999.97	4701300.03
2031	6602991.50	4701293.14
2032	6602851.57	4701403.83
2033	6602591.39	4701437.49
2034	6602931.37	4701316.58
2035	6602927.33	4701309.71
2036	6602545.16	4701440.17
2037	6602612.94	4701474.36
2038	6602671.64	4701549.29
2039	6602706.05	4701482.41
2040	6603003.80	4701302.13
2041	6602565.73	4701468.37
2042	6602578.88	4701455.81
2043	6602599.57	4701455.74
2044	6602619.70	4701562.56
2045	6603000.23	4701279.05
2046	6602894.69	4701391.09

2047	6602972.88	4701345.73
2048	6602833.15	4701379.29
2049	6602668.21	4701430.38
2050	6602611.82	4701500.84
2051	6602582.27	4701491.03
2052	6602694.24	4701466.19
2053	6602901.10	4701423.61
2054	6602894.18	4701359.55
2055	6602566.63	4701439.48
2056	6602572.87	4701447.77
2057	6602626.91	4701458.39
2058	6602869.09	4701356.61
2059	6602867.28	4701354.07
2060	6602987.74	4701290.84
2061	6602938.47	4701346.88
2062	6602940.81	4701350.51
2063	6602586.00	4701465.74
2064	6602780.30	4701460.51
2065	6602760.38	4701433.04
2066	6602609.74	4701497.97
2067	6602839.62	4701410.39
2068	6602651.32	4701564.44
2069	6602666.91	4701577.66
2070	6602935.86	4701342.83
2071	6602666.65	4701549.19
2072	6602865.91	4701423.10
2073	6602868.37	4701426.29
2074	6602985.23	4701360.99
2075	6602981.63	4701356.54
2076	6602797.68	4701407.38
2077	6602816.57	4701432.52
2078	6602897.44	4701435.63
2079	6602887.60	4701438.79
2080	6602653.20	4701558.47
2081	6602878.96	4701370.15
2082	6602556.73	4701426.79
2083	6603035.05	4701290.84
2084	6603039.41	4701298.90
2085	6602940.08	4701289.69
2086	6602946.04	4701359.52
2087	6602712.01	4701535.88
2088	6602934.20	4701456.25

2089	6603016.75	4701335.75
2090	6603022.17	4701346.30
2091	6602845.46	4701405.95
2092	6602834.12	4701431.19
2093	6602875.69	4701442.78
2094	6602638.27	4701509.66
2095	6602638.02	4701474.43
2096	6602607.77	4701495.25
2097	6603008.76	4701322.75
2098	6602706.62	4701549.67
2099	6602643.24	4701594.34
2100	6603013.08	4701329.72
2101	6602745.16	4701495.14
2102	6602980.78	4701376.36
2103	6603003.97	4701284.50
2104	6602914.91	4701394.93
2105	6603015.54	4701293.18
2106	6602969.34	4701377.34
2107	6602965.88	4701371.64
2108	6602879.56	4701442.00
2109	6603000.29	4701315.91
2110	6602961.83	4701364.89
2111	6602869.29	4701487.84
2112	6602872.21	4701491.58
2113	6602888.18	4701454.18
2114	6603013.05	4701378.54
2115	6602613.99	4701503.80
2116	6602921.00	4701427.40
2117	6602940.75	4701450.07
2118	6603033.03	4701324.67
2119	6602986.40	4701402.63
2120	6602606.64	4701544.84
2121	6602584.64	4701563.21
2122	6602986.76	4701370.04
2123	6603001.22	4701391.30
2124	6602974.89	4701387.98
2125	6602977.17	4701390.89
2126	6602972.91	4701383.48
2127	6602887.46	4701412.45
2128	6602891.30	4701415.78
2129	6602874.61	4701417.96
2130	6602936.76	4701364.58

2131	6602990.95	4701277.13
2132	6602608.23	4701596.24
2133	6602596.44	4701579.73
2134	6602960.40	4701431.52
2135	6602840.74	4701428.17
2136	6602617.62	4701517.27
2137	6602607.40	4701525.48
2138	6602947.30	4701443.89
2139	6602926.57	4701420.09
2140	6602982.06	4701411.08
2141	6602968.99	4701391.68
2142	6602966.31	4701388.60
2143	6602900.09	4701477.69
2144	6602876.39	4701485.64
2145	6602879.90	4701483.94
2146	6602645.37	4701547.50
2147	6602658.86	4701538.34
2148	6602865.17	4701462.33
2149	6602967.70	4701406.41
2150	6602814.42	4701509.70
2151	6602812.39	4701506.08
2152	6603005.52	4701294.32
2153	6603025.22	4701274.74
2154	6603018.44	4701262.02
2155	6603047.35	4701346.02
2156	6602899.06	4701356.95
2157	6602918.84	4701315.98
2158	6602996.89	4701277.68
2159	6603003.08	4701318.16
2160	6602789.07	4701590.47
2161	6602756.64	4701550.75
2162	6602995.26	4701397.73
2163	6603045.22	4701308.50
2164	6603003.26	4701348.94
2165	6602907.96	4701435.27
2166	6602905.12	4701433.14
2167	6602921.32	4701320.04
2168	6602928.17	4701330.21
2169	6603004.62	4701306.72
2170	6603003.82	4701311.18
2171	6602879.82	4701447.16
2172	6602997.81	4701355.97

2173	6603029.38	4701281.56
2174	6603015.16	4701255.69
2175	6602946.32	4701341.18
2176	6602942.64	4701344.11
2177	6602870.14	4701444.84
2178	6602878.08	4701488.64
2179	6602873.98	4701458.19
2180	6602504.97	4701512.79
2181	6602581.95	4701460.07
2182	6602978.43	4701406.45
2183	6602969.69	4701396.09
2184	6602947.98	4701343.76
2185	6602940.50	4701332.10
2186	6603039.67	4701320.40
2187	6602849.33	4701463.15
2188	6602852.46	4701508.83
2189	6603054.07	4701340.59
2190	6603021.57	4701332.13
2191	6603009.14	4701342.54
2192	6602976.43	4701416.40
2193	6602882.23	4701452.49
2194	6602950.07	4701347.01
2195	6602930.30	4701361.39
2196	6602963.53	4701381.95
2197	6602819.44	4701481.97
2198	6602805.31	4701566.81
2199	6602480.94	4701514.58
2200	6602932.61	4701413.32
2201	6602953.85	4701437.71
2202	6602625.09	4701519.12
2203	6602901.17	4701455.14
2204	6602905.30	4701456.15
2205	6602914.16	4701478.07
2206	6602946.44	4701401.66
2207	6603007.17	4701384.89
2208	6602790.02	4701550.65
2209	6602784.75	4701542.82
2210	6602927.64	4701408.39
2211	6602923.01	4701402.70
2212	6602767.56	4701515.28
2213	6602782.63	4701578.84
2214	6602909.95	4701457.77

2215	6602812.27	4701572.82
2216	6602869.19	4701460.48
2217	6602966.95	4701425.35
2218	6602799.87	4701532.74
2219	6602916.96	4701460.75
2220	6602915.62	4701452.97
2221	6602971.54	4701331.16
2222	6603024.89	4701365.77
2223	6602981.60	4701397.36
2224	6602881.42	4701503.49
2225	6602878.43	4701499.45
2226	6602831.33	4701540.53
2227	6602823.85	4701527.56
2228	6602601.19	4701664.75
2229	6602759.97	4701556.28
2230	6602574.25	4701616.04
2231	6602915.29	4701435.00
2232	6603019.22	4701371.88
2233	6603013.06	4701363.38
2234	6602857.03	4701524.10
2235	6602733.16	4701564.27
2236	6602772.88	4701527.65
2237	6602953.98	4701352.92
2238	6602971.48	4701410.28
2239	6602765.11	4701517.01
2240	6602566.99	4701590.08
2241	6602854.49	4701515.44
2242	6602768.41	4701566.68
2243	6602844.15	4701489.07
2244	6602674.04	4701597.34
2245	6602721.77	4701549.11
2246	6602720.91	4701570.21
2247	6602799.21	4701517.67
2248	6602642.50	4701649.48
2249	6602715.15	4701580.10
2250	6602820.63	4701549.00
2251	6602863.01	4701506.29
2252	6602549.49	4701573.05
2253	6602537.08	4701582.83
2254	6602761.17	4701571.46
2255	6602828.62	4701472.25
2256	6602830.26	4701496.35

2257	6602860.28	4701476.85
2258	6602690.38	4701569.68
2259	6602593.41	4701625.98
2260	6602877.60	4701523.11
2261	6603040.87	4701351.25
2262	6602616.59	4701653.20
2263	6602810.64	4701535.00
2264	6602858.18	4701467.00
2265	6602855.03	4701470.33
2266	6602678.10	4701594.33
2267	6602554.40	4701665.90
2268	6602532.63	4701642.02
2269	6602792.11	4701538.32
2270	6602855.82	4701521.17
2271	6602553.80	4701532.51
2272	6602851.22	4701504.44
2273	6602700.57	4701562.50
2274	6602961.86	4701399.07
2275	6602495.40	4701531.93
2276	6602976.61	4701183.97
2277	6602842.04	4701524.99
2278	6602670.45	4701599.77
2279	6602728.24	4701562.41
2280	6602719.14	4701590.16
2281	6602471.56	4701505.05
2282	6602478.08	4701511.34
2283	6602893.57	4701478.09
2284	6602807.77	4701498.64
2285	6602802.25	4701490.83
2286	6602863.41	4701533.91
2287	6602577.95	4701566.33
2288	6602667.96	4701615.38
2289	6602939.21	4701407.19
2290	6602653.02	4701629.22
2291	6602872.22	4701447.79
2292	6602816.90	4701513.15
2293	6602782.08	4701539.04
2294	6602751.64	4701579.64
2295	6602717.29	4701587.38
2296	6602483.30	4701582.87
2297	6602559.29	4701610.73
2298	6602867.07	4701511.09

2299	6602548.88	4701597.45
2300	6602813.39	4701539.52
2301	6602534.87	4701547.80
2302	6602604.50	4701669.34
2303	6602690.27	4701590.74
2304	6602547.81	4701564.02
2305	6602559.68	4701580.15
2306	6602568.91	4701682.71
2307	6602591.20	4701708.39
2308	6602606.27	4701641.74
2309	6602602.00	4701637.73
2310	6602573.58	4701658.66
2311	6602558.93	4701671.24
2312	6602854.92	4701497.41
2313	6602473.87	4701542.44
2314	6602497.09	4701602.83
2315	6602493.93	4701599.41
2316	6602499.42	4701592.83
2317	6602507.76	4701583.54
2318	6602648.49	4701656.41
2319	6602775.71	4701574.72
2320	6602509.92	4701531.20
2321	6603028.23	4701212.10
2322	6603031.01	4701216.44
2323	6602529.31	4701637.93
2324	6602547.38	4701593.99
2325	6602827.33	4701561.36
2326	6602837.91	4701553.31
2327	6602648.98	4701602.03
2328	6602953.07	4701367.63
2329	6602666.26	4701602.05
2330	6602653.06	4701607.89
2331	6602661.16	4701619.54
2332	6602472.75	4701598.44
2333	6602485.99	4701612.83
2334	6602762.27	4701560.12
2335	6602625.85	4701666.05
2336	6602632.49	4701675.23
2337	6602573.30	4701569.65
2338	6602570.39	4701572.16
2339	6602680.55	4701576.61
2340	6602935.01	4701181.23

2341	6602570.91	4701618.75
2342	6602457.52	4701559.67
2343	6602507.64	4701522.08
2344	6602504.51	4701524.46
2345	6602569.68	4701624.18
2346	6602946.73	4701174.97
2347	6602587.56	4701646.65
2348	6603041.25	4701195.60
2349	6602581.98	4701668.05
2350	6602521.18	4701531.77
2351	6602700.54	4701584.34
2352	6602952.84	4701096.62
2353	6602909.07	4701113.38
2354	6602957.84	4701193.84
2355	6602566.18	4701549.84
2356	6602958.31	4701241.91
2357	6602685.30	4701641.84
2358	6602525.68	4701568.78
2359	6602511.53	4701581.82
2360	6602994.53	4701217.14
2361	6602595.11	4701590.35
2362	6602585.29	4701576.60
2363	6603015.07	4701224.77
2364	6602616.86	4701622.22
2365	6602670.83	4701583.46
2366	6602511.94	4701619.34
2367	6602516.79	4701624.53
2368	6602861.42	4701464.38
2369	6603069.90	4701215.54
2370	6602932.62	4701151.28
2371	6602935.87	4701159.03
2372	6602578.65	4701612.68
2373	6602562.44	4701675.31
2374	6602684.94	4701604.93
2375	6602680.59	4701598.02
2376	6602582.98	4701641.36
2377	6602976.80	4701232.12
2378	6602967.99	4701215.53
2379	6602987.03	4701203.41
2380	6603027.60	4701202.02
2381	6602523.42	4701653.51
2382	6602997.13	4701221.86

2383	6602977.75	4701108.11
2384	6602970.74	4701089.77
2385	6602993.57	4701256.52
2386	6602528.94	4701573.20
2387	6602943.31	4701176.95
2388	6602464.72	4701589.64
2389	6602469.14	4701594.49
2390	6602594.95	4701713.15
2391	6602481.31	4701495.61
2392	6602555.80	4701587.17
2393	6603021.45	4701112.04
2394	6603048.51	4701210.11
2395	6603043.02	4701199.15
2396	6602517.03	4701557.90
2397	6603033.33	4701179.70
2398	6603036.03	4701185.18
2399	6602854.45	4701540.72
2400	6602521.60	4701629.68
2401	6602557.79	4701584.33
2402	6602578.82	4701636.00
2403	6602598.25	4701687.82
2404	6602953.59	4701144.06
2405	6602609.33	4701676.31
2406	6602611.65	4701679.21
2407	6603038.45	4701189.96
2408	6602998.73	4701155.25
2409	6602430.21	4701723.47
2410	6602556.35	4701636.17
2411	6603055.73	4701227.05
2412	6602543.48	4701590.41
2413	6602529.23	4701603.28
2414	6602513.11	4701528.48
2415	6603024.27	4701118.48
2416	6602500.96	4701538.43
2417	6602488.00	4701492.93
2418	6602507.24	4701706.40
2419	6602597.50	4701660.01
2420	6602475.26	4701579.75
2421	6603029.38	4701173.36
2422	6603021.38	4701176.71
2423	6602994.21	4701188.66
2424	6602446.91	4701715.65

2425	6602416.30	4701708.32
2426	6602937.06	4701204.55
2427	6602982.14	4701229.39
2428	6602511.30	4701640.35
2429	6602988.91	4701146.68
2430	6602956.21	4701170.00
2431	6602986.05	4701238.50
2432	6602508.62	4701547.52
2433	6602517.13	4701540.59
2434	6602577.00	4701603.69
2435	6602521.42	4701538.22
2436	6602486.82	4701558.14
2437	6602470.59	4701574.21
2438	6602522.59	4701498.70
2439	6602623.04	4701661.51
2440	6602421.97	4701663.99
2441	6603015.66	4701219.57
2442	6602477.82	4701609.85
2443	6602463.06	4701623.65
2444	6602504.65	4701611.00
2445	6602945.87	4701123.36
2446	6602970.41	4701111.46
2447	6603013.85	4701213.00
2448	6603077.22	4701216.87
2449	6603032.67	4701135.29
2450	6602440.80	4701605.07
2451	6602389.28	4701719.47
2452	6602432.85	4701675.54
2453	6602417.87	4701689.03
2454	6602403.77	4701644.66
2455	6602403.18	4701647.98
2456	6602367.84	4701740.80
2457	6602413.42	4701736.24
2458	6602968.85	4701170.07
2459	6603020.85	4701155.60
2460	6603009.81	4701139.94
2461	6602952.27	4701140.87
2462	6603034.58	4701139.90
2463	6602802.60	4701531.33
2464	6603088.66	4701204.70
2465	6603086.18	4701199.75
2466	6603091.41	4701210.15

2467	6602403.96	4701611.87
2468	6602480.62	4701585.40
2469	6603012.19	4701221.88
2470	6602465.20	4701656.07
2471	6602508.59	4701673.84
2472	6602437.20	4701647.44
2473	6602471.18	4701716.26
2474	6602566.90	4701629.11
2475	6602461.03	4701627.36
2476	6602437.87	4701710.30
2477	6602428.83	4701665.44
2478	6602343.49	4701792.74
2479	6602714.55	4701583.35
2480	6602614.04	4701650.13
2481	6603057.78	4701188.07
2482	6602481.75	4701675.21
2483	6602448.95	4701638.05
2484	6602439.45	4701696.11
2485	6603011.12	4701248.20
2486	6603031.43	4701175.80
2487	6602567.39	4701621.22
2488	6602382.86	4701750.18
2489	6602390.36	4701742.97
2490	6602945.52	4701219.43
2491	6602528.09	4701647.68
2492	6602414.00	4701684.87
2493	6602350.50	4701729.82
2494	6602918.90	4701139.05
2495	6602455.08	4701666.58
2496	6602457.95	4701752.96
2497	6602467.76	4701742.88
2498	6602340.75	4701719.24
2499	6602459.27	4701697.76
2500	6602385.54	4701791.91
2501	6602408.08	4701643.40
2502	6602911.75	4701120.38
2503	6602913.67	4701125.40
2504	6603039.86	4701234.58
2505	6602722.11	4701575.25
2506	6602926.36	4701185.75
2507	6603022.09	4701239.48
2508	6602300.85	4701767.05

2509	6602408.25	4701597.39
2510	6602368.44	4701777.67
2511	6602358.17	4701793.14
2512	6602369.32	4701773.20
2513	6602542.60	4701625.79
2514	6603011.78	4701180.99
2515	6603025.53	4701206.95
2516	6602354.63	4701725.88
2517	6602446.36	4701689.89
2518	6603003.28	4701164.10
2519	6602416.80	4701682.61
2520	6602392.15	4701712.14
2521	6602327.70	4701815.79
2522	6602326.76	4701724.45
2523	6602944.09	4701145.11
2524	6602419.04	4701632.41
2525	6602386.18	4701738.46
2526	6602545.51	4701623.03
2527	6602474.02	4701686.86
2528	6602376.08	4701643.79
2529	6602362.83	4701801.80
2530	6603061.76	4701187.18
2531	6602338.54	4701799.98
2532	6602342.06	4701802.73
2533	6602399.87	4701720.89
2534	6602410.30	4701709.99
2535	6602355.96	4701796.60
2536	6602496.67	4701715.49
2537	6602439.68	4701654.49
2538	6602475.94	4701643.80
2539	6602327.73	4701780.08
2540	6602458.27	4701732.73
2541	6602350.95	4701757.89
2542	6602449.23	4701608.40
2543	6602425.67	4701750.12
2544	6602407.56	4701740.18
2545	6602437.83	4701737.69
2546	6602994.31	4701146.63
2547	6602425.56	4701796.27
2548	6602497.22	4701570.75
2549	6602322.16	4701763.37
2550	6602433.48	4701758.97

2551	6602425.48	4701724.24
2552	6603043.19	4701167.15
2553	6602357.31	4701723.25
2554	6602376.03	4701704.46
2555	6603023.47	4701242.34
2556	6602351.03	4701843.82
2557	6603052.60	4701219.07
2558	6602344.85	4701853.45
2559	6602509.12	4701643.88
2560	6602422.35	4701756.94
2561	6602494.14	4701657.91
2562	6602385.98	4701870.20
2563	6602401.88	4701776.13
2564	6602324.66	4701784.10
2565	6602508.24	4701679.41
2566	6602431.82	4701704.02
2567	6602333.52	4701713.22
2568	6602261.45	4701888.47
2569	6602351.56	4701787.62
2570	6602491.12	4701608.12
2571	6602415.17	4701815.38
2572	6602334.24	4701786.44
2573	6602404.70	4701861.42
2574	6602389.31	4701789.85
2575	6602404.35	4701802.38
2576	6602365.23	4701743.44
2577	6602450.76	4701580.24
2578	6602436.49	4701594.36
2579	6602364.51	4701650.83
2580	6602402.32	4701863.95
2581	6602406.77	4701816.60
2582	6602410.14	4701819.29
2583	6602981.40	4701126.77
2584	6603028.36	4701126.53
2585	6603026.05	4701121.94
2586	6602495.93	4701629.54
2587	6602481.60	4701644.08
2588	6602305.58	4701770.51
2589	6602414.89	4701864.47
2590	6602346.61	4701794.73
2591	6602501.97	4701570.23
2592	6602397.26	4701728.51

2593	6602374.83	4701806.49
2594	6602269.05	4701960.73
2595	6602375.87	4701634.45
2596	6602355.21	4701616.34
2597	6602523.47	4701659.47
2598	6602345.71	4701824.86
2599	6602314.41	4701805.34
2600	6602303.82	4701820.37
2601	6602494.33	4701621.90
2602	6602339.83	4701702.75
2603	6602385.06	4701761.49
2604	6602251.77	4701900.48
2605	6602391.72	4701733.33
2606	6602293.39	4701835.98
2607	6602413.61	4701879.64
2608	6602389.82	4701757.43
2609	6602337.31	4701775.36
2610	6602348.61	4701761.14
2611	6602332.82	4701747.99
2612	6602294.53	4701784.62
2613	6602309.21	4701753.41
2614	6602306.75	4701757.43
2615	6602330.77	4701775.99
2616	6602332.09	4702027.46
2617	6602326.36	4702024.86
2618	6603046.26	4701165.69
2619	6602362.87	4701991.95
2620	6602002.90	4701905.81
2621	6602408.59	4701863.64
2622	6602315.77	4701801.32
2623	6602324.01	4701789.02
2624	6602333.82	4701772.34
2625	6602348.16	4701727.19
2626	6602423.56	4701822.40
2627	6602230.26	4701873.40
2628	6602301.96	4701974.57
2629	6602407.48	4701875.72
2630	6602234.49	4701776.61
2631	6602444.47	4701717.98
2632	6602441.34	4701714.64
2633	6602375.03	4701861.42
2634	6602427.02	4701824.28

2635	6602419.02	4701825.88
2636	6602254.98	4701834.80
2637	6602321.22	4701782.11
2638	6602298.96	4701770.13
2639	6602339.16	4701824.80
2640	6602327.63	4701841.43
2641	6602301.35	4702009.85
2642	6602294.49	4702005.77
2643	6602430.76	4701813.87
2644	6602437.95	4701805.34
2645	6602455.91	4701730.21
2646	6602381.74	4701758.70
2647	6602410.53	4701838.64
2648	6602243.65	4701910.61
2649	6602302.79	4701746.83
2650	6602420.02	4701791.92
2651	6602426.33	4701698.26
2652	6602314.40	4701777.06
2653	6603150.32	4701059.26
2654	6602278.03	4701801.98
2655	6603054.77	4701224.20
2656	6602354.97	4701837.23
2657	6603127.52	4701114.38
2658	6602419.75	4701818.20
2659	6602445.13	4701799.06
2660	6603191.30	4701106.17
2661	6603183.42	4701088.89
2662	6602283.30	4701998.00
2663	6602342.40	4701629.13
2664	6602928.50	4701132.46
2665	6602444.72	4701781.15
2666	6602348.58	4701785.06
2667	6602201.30	4701769.93
2668	6602419.78	4701847.17
2669	6602372.77	4701809.33
2670	6602120.57	4701938.28
2671	6602219.61	4701786.60
2672	6602220.16	4701950.76
2673	6602252.95	4702000.50
2674	6602264.72	4701984.47
2675	6602013.58	4701882.95
2676	6603129.01	4701110.41

2677	6602293.96	4701979.78
2678	6602412.22	4701810.41
2679	6602251.59	4701760.84
2680	6602244.09	4701727.23
2681	6602265.51	4701746.40
2682	6602259.96	4701812.38
2683	6602459.40	4701703.74
2684	6602452.48	4701710.34
2685	6602307.17	4701845.32
2686	6602796.51	4701556.07
2687	6602274.42	4701965.70
2688	6602434.52	4701832.14
2689	6602269.25	4701934.41
2690	6603135.42	4701131.66
2691	6602194.47	4701929.97
2692	6602007.29	4702176.14
2693	6602452.31	4701792.78
2694	6602357.31	4701833.98
2695	6602368.21	4701818.31
2696	6602235.92	4701962.96
2697	6602317.73	4701722.00
2698	6602210.16	4701916.02
2699	6602337.97	4701866.17
2700	6601952.88	4701861.77
2701	6602280.64	4701942.79
2702	6602000.24	4702170.13
2703	6602213.40	4701959.22
2704	6602111.43	4701865.47
2705	6602225.48	4701784.52
2706	6602494.02	4701663.73
2707	6602268.67	4701749.18
2708	6602204.94	4702414.55
2709	6602201.05	4702416.10
2710	6602287.58	4702141.17
2711	6602306.16	4702163.21
2712	6602287.62	4701727.83
2713	6602279.56	4701957.65
2714	6602204.35	4701938.16
2715	6603139.69	4701133.01
2716	6602291.52	4701986.51
2717	6602270.02	4701778.36
2718	6602279.03	4701784.55

2719	6602244.48	4701768.08
2720	6602242.57	4701968.38
2721	6602132.36	4702366.24
2722	6602333.59	4701815.33
2723	6602278.41	4701692.98
2724	6602093.33	4701899.90
2725	6602211.94	4701780.36
2726	6602296.48	4701864.86
2727	6602304.55	4701854.67
2728	6602315.68	4701833.09
2729	6602198.54	4702417.91
2730	6602311.93	4701965.15
2731	6602403.37	4701832.01
2732	6602398.05	4701827.06
2733	6603189.71	4701110.15
2734	6602299.31	4702120.27
2735	6602293.88	4702115.83
2736	6602429.19	4701826.67
2737	6602172.41	4701993.50
2738	6602184.56	4701978.72
2739	6602197.11	4701842.14
2740	6602218.79	4701862.31
2741	6602258.76	4702039.03
2742	6602494.20	4701771.81
2743	6602238.83	4701841.01
2744	6602223.62	4701789.86
2745	6602205.69	4701916.28
2746	6602193.99	4701906.66
2747	6602216.74	4702204.82
2748	6602414.80	4701832.64
2749	6602126.58	4701909.72
2750	6602334.82	4701744.45
2751	6602340.41	4701739.24
2752	6602263.36	4701773.23
2753	6602287.12	4701992.39
2754	6602238.56	4701911.83
2755	6602225.86	4701928.73
2756	6602312.03	4702038.82
2757	6602265.43	4701705.94
2758	6602305.40	4702102.12
2759	6601995.98	4701857.92
2760	6602229.35	4701751.64

2761	6602224.70	4701746.59
2762	6602288.98	4702002.13
2763	6602267.52	4702147.19
2764	6601992.71	4701913.46
2765	6602277.32	4701949.17
2766	6602175.59	4702356.27
2767	6602254.43	4701950.54
2768	6602182.64	4701920.16
2769	6602059.77	4701902.74
2770	6602463.20	4701760.81
2771	6602228.75	4701981.71
2772	6602153.37	4702262.04
2773	6602250.23	4701946.83
2774	6602334.96	4702124.97
2775	6602320.34	4702154.26
2776	6602230.23	4701788.92
2777	6602088.55	4702396.79
2778	6602320.29	4701705.25
2779	6602324.90	4701710.09
2780	6602212.01	4701944.25
2781	6602194.02	4702458.93
2782	6602261.01	4701771.25
2783	6602184.48	4702381.24
2784	6602238.90	4701761.92
2785	6602487.37	4701764.65
2786	6602227.27	4702038.14
2787	6602192.39	4701953.47
2788	6602208.19	4701965.74
2789	6602284.37	4701731.31
2790	6601945.60	4701850.73
2791	6602308.28	4702103.98
2792	6602286.88	4701947.38
2793	6602404.63	4701701.53
2794	6602271.33	4701795.83
2795	6602233.69	4701756.36
2796	6602224.71	4702294.13
2797	6602504.71	4701751.18
2798	6602196.90	4702422.22
2799	6603179.44	4701087.40
2800	6602004.00	4701869.32
2801	6601984.76	4701841.95
2802	6602536.99	4701556.56

2803	6602206.24	4702182.94
2804	6602195.60	4702191.62
2805	6601972.09	4701890.94
2806	6602506.54	4701727.20
2807	6602188.48	4702229.42
2808	6602182.02	4702375.77
2809	6602319.61	4702021.13
2810	6602020.51	4701892.80
2811	6602163.75	4702305.33
2812	6602157.62	4702300.56
2813	6602035.75	4701975.01
2814	6601981.76	4701905.62
2815	6601988.96	4701916.54
2816	6602198.19	4702434.26
2817	6602195.93	4701904.35
2818	6602140.01	4701919.28
2819	6602084.76	4701915.42
2820	6602010.98	4701884.81
2821	6602500.40	4701745.69
2822	6602495.96	4701739.91
2823	6602560.59	4701690.90
2824	6602568.10	4701697.52
2825	6602326.73	4702118.65
2826	6602094.63	4702079.32
2827	6602199.86	4702219.54
2828	6602023.86	4701932.71
2829	6602033.78	4701944.05
2830	6602139.79	4701831.31
2831	6602334.31	4701694.44
2832	6602091.74	4702395.13
2833	6602096.97	4702395.20
2834	6602049.87	4701962.58
2835	6602152.05	4701904.27
2836	6602185.03	4702428.56
2837	6602177.90	4702432.13
2838	6602180.19	4702284.59
2839	6602528.37	4701757.11
2840	6602014.17	4701941.09
2841	6602090.15	4702296.52
2842	6602138.22	4702285.74
2843	6602306.90	4701664.55
2844	6601979.10	4701868.67

2845	6601963.83	4701878.40
2846	6602477.32	4701775.57
2847	6602312.10	4702106.72
2848	6602140.30	4702187.25
2849	6602047.25	4701964.88
2850	6602202.80	4701993.54
2851	6602065.88	4702408.59
2852	6602186.32	4702184.95
2853	6602294.04	4701677.39
2854	6602262.96	4702230.74
2855	6602074.33	4702370.99
2856	6602320.52	4702113.68
2857	6602544.08	4701753.82
2858	6602057.46	4701937.19
2859	6602063.86	4701942.97
2860	6602221.03	4702008.36
2861	6602310.69	4702143.51
2862	6602153.89	4702340.97
2863	6602177.48	4702316.01
2864	6602181.46	4702388.86
2865	6602489.30	4701737.10
2866	6602517.88	4701767.32
2867	6602511.95	4701760.11
2868	6602136.46	4702222.85
2869	6602156.04	4702202.10
2870	6602302.66	4701710.88
2871	6602169.39	4701942.57
2872	6602128.85	4701848.54
2873	6602072.96	4701926.20
2874	6602190.22	4702326.23
2875	6602187.71	4702324.33
2876	6602058.68	4702000.33
2877	6602074.51	4701987.95
2878	6602194.74	4702152.27
2879	6602202.96	4702160.67
2880	6602118.67	4702096.52
2881	6602108.77	4701959.73
2882	6602154.32	4702108.65
2883	6602170.27	4702170.28
2884	6602110.63	4701860.42
2885	6602303.24	4702135.39
2886	6602299.92	4702133.18

2887	6602106.38	4701864.66
2888	6602087.69	4701883.31
2889	6602184.42	4702442.25
2890	6602180.94	4702435.85
2891	6602066.13	4701945.01
2892	6602072.50	4701951.90
2893	6602021.51	4701934.79
2894	6602047.50	4702215.84
2895	6602199.92	4702176.25
2896	6602208.81	4702023.47
2897	6602165.72	4702166.13
2898	6602527.99	4701731.43
2899	6602112.00	4701941.93
2900	6602198.75	4702443.44
2901	6602198.50	4702439.05
2902	6602196.66	4701963.75
2903	6601976.88	4701830.74
2904	6602511.86	4701711.66
2905	6602146.73	4702184.72
2906	6602119.43	4702248.74
2907	6602252.35	4702007.01
2908	6602044.27	4701920.74
2909	6602239.27	4702023.18
2910	6602028.39	4702165.69
2911	6602089.33	4702293.03
2912	6602160.33	4702197.55
2913	6602180.50	4702179.63
2914	6602187.03	4702143.64
2915	6602009.38	4701944.65
2916	6602215.23	4701978.17
2917	6602092.57	4701944.59
2918	6602077.06	4701930.04
2919	6602019.52	4702206.51
2920	6602139.95	4702137.42
2921	6602128.54	4702290.37
2922	6602525.29	4701727.75
2923	6602047.52	4701988.01
2924	6602120.89	4702213.57
2925	6602501.13	4701751.41
2926	6602493.73	4701742.05
2927	6602110.85	4701991.63
2928	6602233.79	4701992.59

2929	6601967.01	4702258.39
2930	6602004.12	4702342.20
2931	6602041.42	4702011.78
2932	6601963.89	4702070.79

2933	6601969.67	4702078.11
2934	6602205.77	4702084.50
2935	6602014.28	4702065.39
2936	6601813.79	4701892.42

2937	6601855.94	4701814.69
2938	6601895.78	4701839.73

KOORDINATE TJEMENA REGULACIONIH LINIJA

1	6602323.47	4701964.74
2	6602330.54	4701967.98
3	6602345.65	4701979.36
4	6602359.64	4701989.58
5	6602347.40	4701974.25
6	6602328.40	4701959.82
7	6602336.55	4701945.19
8	6602358.34	4701885.91
9	6602349.01	4701906.41
10	6602372.00	4701888.48
11	6602389.91	4701899.71
12	6602384.99	4701916.67
13	6602379.41	4701928.07
14	6602373.97	4701943.09
15	6602386.68	4701928.12
16	6602391.30	4701912.56
17	6602394.21	4701905.58
18	6602397.19	4701900.75
19	6602362.73	4701878.63
20	6602380.29	4701850.90
21	6602367.42	4701870.85
22	6602393.21	4701861.22
23	6602399.94	4701867.19
24	6602401.77	4701872.16
25	6602404.95	4701866.39
26	6602392.61	4701855.49
27	6602422.88	4701799.02
28	6602440.02	4701781.41
29	6602469.28	4701808.96
30	6602457.27	4701818.39
31	6602441.11	4701837.83
32	6602429.44	4701855.89
33	6602422.61	4701869.79
34	6602416.48	4701881.80
35	6602411.86	4701890.97
36	6602404.46	4701906.97
37	6602420.87	4701921.01
38	6602403.22	4701942.79
39	6602396.40	4701961.78
40	6602387.86	4701972.15

41	6602382.16	4701980.54
42	6602368.49	4701997.02
43	6602355.61	4702010.82
44	6602351.95	4702015.85
45	6602339.15	4702033.45
46	6602328.92	4702049.62
47	6602319.04	4702062.65
48	6602327.95	4702070.32
49	6602296.63	4702108.67
50	6602275.85	4702067.77
51	6602257.95	4702054.09
52	6602261.19	4702062.84
53	6602276.81	4702022.40
54	6602310.19	4702041.38
55	6602296.68	4702029.00
56	6602283.16	4702022.13
57	6602286.21	4702006.59
58	6602300.39	4701986.73
59	6602331.24	4702002.63
60	6602306.56	4701979.88
61	6602342.35	4701904.26
62	6602350.20	4701886.02
63	6602349.31	4701880.55
64	6602266.67	4701824.64
65	6602261.29	4701826.18
66	6602239.04	4701855.01
67	6602293.90	4701883.85
68	6602286.13	4701904.01
69	6602310.78	4701919.75
70	6602174.66	4702483.87
71	6602202.74	4702447.69
72	6602208.76	4702445.73
73	6602214.89	4702437.76
74	6602213.63	4702427.81
75	6602212.62	4702419.75
76	6602208.95	4702411.68
77	6602214.11	4702403.91
78	6602211.70	4702393.57
79	6602210.92	4702380.89
80	6602207.45	4702371.88

81	6602204.67	4702362.75
82	6602207.02	4702346.01
83	6602208.18	4702339.78
84	6602209.42	4702333.11
85	6602212.07	4702310.42
86	6602269.08	4702236.98
87	6602319.35	4702176.23
88	6602330.35	4702162.72
89	6602342.42	4702147.93
90	6602344.66	4702131.89
91	6602350.26	4702087.03
92	6602345.04	4702081.99
93	6602337.84	4702077.07
94	6602327.61	4702079.44
95	6602321.13	4702083.41
96	6602235.39	4702185.40
97	6602206.13	4702213.84
98	6602213.06	4702208.09
99	6602167.05	4702248.01
100	6602133.23	4702297.48
101	6602128.24	4702308.37
102	6602165.54	4702345.15
103	6602185.05	4702373.11
104	6602175.39	4702378.25
105	6602173.10	4702373.61
106	6602177.14	4702367.91
107	6602170.44	4702356.52
108	6602143.89	4702331.58
109	6602128.89	4702320.15
110	6602107.66	4702337.03
111	6602120.33	4702321.52
112	6602414.16	4701579.03
113	6602053.33	4702387.74
114	6602083.68	4702361.90
115	6602410.33	4701584.73
116	6602408.05	4701568.96
117	6602335.06	4701636.45
118	6602354.68	4701664.13
119	6602334.74	4701646.72
120	6602348.20	4701661.98

121	6602359.17	4701658.53
122	6603027.20	4701320.10
123	6603006.87	4701299.23
124	6603011.75	4701302.99
125	6603021.95	4701311.60
126	6603017.21	4701307.43
127	6603057.07	4701300.88
128	6603049.47	4701289.74
129	6603036.60	4701267.49
130	6602981.81	4701284.48
131	6602976.39	4701274.06
132	6603027.23	4701249.97
133	6602984.72	4701293.62
134	6602983.35	4701329.89
135	6602980.54	4701302.79
136	6602985.36	4701325.26
137	6602982.88	4701317.02
138	6602979.61	4701311.56
139	6602980.06	4701289.43
140	6602974.31	4701279.51
141	6602977.69	4701316.53
142	6602933.45	4701305.19
143	6602915.48	4701339.63
144	6602906.12	4701325.38
145	6602902.33	4701330.21
146	6602913.33	4701352.72
147	6602870.27	4701435.44
148	6602919.87	4701345.85
149	6602907.57	4701385.56
150	6602907.90	4701369.84
151	6602889.50	4701342.99
152	6602890.30	4701480.39
153	6602868.58	4701449.57
154	6602836.79	4701466.49
155	6602766.08	4701518.62
156	6602851.16	4701499.03
157	6602832.80	4701472.97
158	6602859.38	4701448.84
159	6602761.32	4701523.63
160	6602847.76	4701458.75
161	6602739.26	4701564.10
162	6602743.16	4701552.13

163	6602751.91	4701533.17
164	6602751.44	4701542.17
165	6602748.17	4701549.53
166	6602638.28	4701645.03
167	6602630.41	4701631.09
168	6602598.70	4701637.08
169	6602640.37	4701636.96
170	6602624.93	4701616.05
171	6602636.69	4701650.35
172	6602739.69	4701558.80
173	6602501.21	4701720.81
174	6602735.33	4701567.63
175	6602521.39	4701773.75
176	6602670.05	4701618.79
177	6602459.15	4701787.01
178	6602475.24	4701773.40
179	6602583.59	4701731.54
180	6602447.22	4701777.93
181	6602460.92	4701793.45
182	6602496.17	4701725.14
183	6602636.21	4701607.86
184	6602747.47	4701529.44
185	6602480.10	4701740.24
186	6602545.24	4701757.57
187	6602592.17	4701715.77
188	6602619.46	4701688.81
189	6602626.68	4701682.54
190	6602621.32	4701623.11
191	6602634.79	4701678.66
192	6602619.02	4701695.49
193	6602680.36	4701644.94
194	6602505.69	4701783.91
195	6602610.28	4701701.41
196	6602758.23	4701595.50
197	6602769.67	4701605.23
198	6602598.69	4701721.29
199	6602533.30	4701765.67
200	6602701.51	4701607.92
201	6602708.46	4701605.33
202	6602648.34	4701667.31
203	6602654.12	4701662.61
204	6602661.28	4701659.59

205	6603064.49	4701331.37
206	6602602.81	4701707.91
207	6602697.43	4701624.88
208	6602670.67	4701653.35
209	6602691.46	4701614.85
210	6602478.53	4701802.85
211	6602493.60	4701792.61
212	6602920.35	4701469.32
213	6602992.94	4701362.45
214	6603024.82	4701329.95
215	6603000.04	4701353.00
216	6602696.99	4701634.52
217	6603049.39	4701314.15
218	6602924.39	4701422.89
219	6602746.53	4701583.68
220	6602887.81	4701515.34
221	6602906.12	4701430.14
222	6602960.78	4701392.37
223	6602949.17	4701399.83
224	6602994.44	4701348.80
225	6603030.84	4701359.35
226	6603060.49	4701335.40
227	6602752.08	4701589.39
228	6602988.59	4701404.92
229	6603021.04	4701324.06
230	6602190.59	4702024.94
231	6602956.99	4701386.48
232	6602987.34	4701358.25
233	6602913.12	4701439.14
234	6602918.79	4701418.68
235	6602146.54	4702074.47
236	6602175.02	4702042.17
237	6602713.02	4701601.62
238	6602723.55	4701597.04
239	6602234.78	4702055.61
240	6602181.83	4702120.92
241	6602210.33	4702099.37
242	6602216.29	4702094.62
243	6602227.68	4702049.96
244	6602241.99	4702066.48
245	6602220.82	4702090.64
246	6602240.92	4702060.25

247	6602197.39	4702025.89
248	6602161.36	4702048.21
249	6602175.65	4702120.21
250	6602141.24	4702083.13
251	6602106.78	4702063.14
252	6602098.01	4702020.91
253	6602167.95	4702110.95
254	6602147.19	4702091.60
255	6602087.52	4702033.40
256	6602082.13	4702039.81
257	6602183.65	4702032.38
258	6602184.66	4702021.78
259	6602170.15	4702038.24
260	6602236.45	4702073.91
261	6602153.24	4702057.42
262	6602945.39	4701393.94
263	6603174.88	4701048.47
264	6602184.11	4702015.31
265	6602142.96	4701975.41
266	6602156.53	4701988.99
267	6602135.18	4701976.66
268	6603208.78	4701077.18
269	6602129.04	4702078.81
270	6602135.00	4702078.11
271	6603213.84	4701031.98
272	6603198.43	4701117.99
273	6603181.76	4701125.48
274	6603252.37	4701126.58
275	6603222.61	4701107.08
276	6603204.21	4701115.52
277	6602082.98	4702046.38
278	6603110.29	4701096.65
279	6603074.02	4701119.86
280	6603107.81	4701147.58
281	6603185.54	4701072.77
282	6603203.48	4701149.61
283	6603203.16	4701064.86
284	6602118.25	4701996.81
285	6603072.52	4701094.47
286	6603101.80	4701081.22
287	6603080.74	4701090.75
288	6603220.42	4701047.19

289	6602791.57	4701246.72
290	6602808.41	4701271.43
291	6603250.48	4701121.57
292	6603240.91	4701096.17
293	6603161.10	4701134.79
294	6603140.43	4701144.32
295	6602795.61	4701243.77
296	6603059.00	4701100.60
297	6602813.83	4701230.48
298	6603138.34	4701139.73
299	6603114.28	4701150.70
300	6602863.50	4701208.31
301	6602809.70	4701233.49
302	6603227.88	4701065.31
303	6602847.86	4701243.60
304	6602839.27	4701229.57
305	6602860.27	4701203.81
306	6602847.90	4701248.71
307	6602856.88	4701199.10
308	6602858.45	4701240.10
309	6603129.01	4701137.89
310	6603064.72	4701108.34
311	6602876.99	4701221.48
312	6602861.02	4701196.16
313	6602829.59	4701218.98
314	6602926.13	4701300.03
315	6602825.88	4701258.73
316	6602963.18	4701272.66
317	6602851.48	4701203.00
318	6602964.42	4701266.81
319	6602875.39	4701226.96
320	6602910.54	4701274.30
321	6602730.13	4701312.19
322	6602720.33	4701298.70
323	6602861.99	4701304.50
324	6602882.87	4701331.99
325	6602856.97	4701305.26
326	6602776.92	4701373.73
327	6602798.61	4701394.23
328	6603138.09	4701183.40
329	6602795.25	4701295.93
330	6602740.79	4701431.38

331	6602999.42	4701118.82
332	6602910.63	4701285.72
333	6602913.69	4701290.87
334	6602725.61	4701305.79
335	6602909.35	4701170.02
336	6602877.55	4701335.92
337	6602903.09	4701168.41
338	6603020.85	4701155.60
339	6602748.28	4701431.42
340	6603004.84	4701116.54
341	6602920.43	4701304.24
342	6602914.53	4701164.96
343	6602963.24	4701135.37
344	6603035.93	4701112.46
345	6603023.42	4701109.10
346	6602977.47	4701264.14
347	6603018.01	4701142.52
348	6602785.43	4701280.91
349	6602737.71	4701323.26
350	6602671.40	4701338.18
351	6603054.56	4701135.56
352	6602780.16	4701378.11
353	6602950.47	4701228.13
354	6602970.33	4701263.04
355	6602741.48	4701283.26
356	6602771.30	4701261.51
357	6603069.93	4701220.33
358	6603073.39	4701213.53
359	6603042.59	4701153.67
360	6602026.94	4702107.73
361	6602162.46	4702114.12
362	6602100.65	4702147.48
363	6602120.46	4702170.13
364	6602088.63	4702191.89
365	6602757.53	4701304.85
366	6602763.79	4701313.22
367	6602966.12	4701209.73
368	6602162.46	4702242.72
369	6602176.37	4702230.66
370	6602081.71	4702181.75
371	6602143.59	4702096.71
372	6602971.55	4701213.68

373	6602177.39	4702225.14
374	6602013.20	4702126.26
375	6602126.74	4702294.87
376	6602103.89	4702325.28
377	6602529.06	4701687.66
378	6602072.05	4702202.03
379	6602061.06	4702196.64
380	6602171.06	4702124.68
381	6602094.57	4702187.19
382	6602081.90	4702176.65
383	6602110.71	4702177.51
384	6602535.75	4701681.92
385	6602536.80	4701676.40
386	6602437.63	4701565.81
387	6602076.82	4702051.57
388	6602949.51	4701220.61
389	6602076.22	4702209.59
390	6602125.04	4702163.85
391	6602168.45	4702131.03
392	6602109.63	4702324.19
393	6602071.32	4702052.68
394	6602047.50	4702081.03
395	6602469.81	4701601.15
396	6602110.55	4702182.64
397	6601877.40	4702020.35
398	6601870.80	4702001.66
399	6601829.06	4702056.28
400	6602466.18	4701597.18
401	6602127.74	4702175.91
402	6602120.01	4702175.49
403	6601823.05	4702054.77
404	6602085.93	4702206.67
405	6601838.95	4702050.71
406	6601875.12	4702028.34
407	6602423.77	4701574.15
408	6602424.53	4701581.17
409	6602426.67	4701569.09
410	6601756.80	4701953.26
411	6601814.61	4702041.66
412	6601847.78	4702026.17
413	6602523.45	4701687.87
414	6602229.09	4702177.92

415	6601980.14	4702165.92
416	6601978.86	4702172.52
417	6601753.12	4701947.62
418	6601764.54	4701883.52
419	6601763.48	4701889.04
420	6601862.91	4701986.33
421	6602256.53	4702068.66
422	6601789.63	4701931.57
423	6602392.57	4701620.00
424	6601767.78	4701836.53
425	6601706.66	4701867.45
426	6602247.89	4702070.25
427	6602203.58	4701881.64
428	6601704.93	4701873.93
429	6602180.37	4701897.65
430	6601775.21	4701837.94
431	6602234.79	4702175.25
432	6602160.88	4701878.74
433	6601782.55	4701925.12
434	6602158.60	4701812.54
435	6602096.93	4701885.80
436	6602273.62	4702074.41
437	6601994.31	4702207.58
438	6602149.34	4701868.40
439	6602206.89	4701857.42
440	6601914.10	4702231.45
441	6602096.60	4701898.75
442	6602134.74	4701955.32
443	6602517.97	4701692.58
444	6602186.69	4702126.02
445	6602424.40	4701586.99
446	6602415.03	4701587.60
447	6602029.03	4702394.70
448	6602393.14	4701627.53
449	6602489.66	4701721.52
450	6602157.93	4701935.59
451	6603110.78	4701077.15
452	6602160.47	4701883.72
453	6602103.01	4701873.00
454	6602109.19	4701867.47
455	6602184.56	4701836.66
456	6602215.84	4701865.74

457	6602097.43	4702337.55
458	6602097.67	4702331.58
459	6602329.89	4701943.05
460	6602193.16	4701893.65
461	6602127.41	4701881.91
462	6602117.30	4701891.49
463	6603139.52	4701093.74
464	6603121.94	4701101.76
465	6602038.70	4702388.87
466	6602403.99	4701616.29
467	6601922.01	4702246.93
468	6601929.04	4702257.74
469	6602078.64	4702357.04
470	6601938.69	4702208.49
471	6602285.11	4702115.38
472	6601753.57	4701874.45
473	6601936.31	4701836.63
474	6602297.69	4701916.31
475	6601998.89	4702259.81
476	6602119.85	4701896.60
477	6601974.99	4702226.08
478	6601867.06	4701791.53
479	6602280.60	4701905.21
480	6602124.12	4701904.78
481	6601994.25	4702262.53
482	6602134.32	4701888.11
483	6602145.70	4701877.32
484	6602215.45	4701881.88
485	6602173.73	4701891.20
486	6602141.49	4701955.16
487	6603127.62	4701069.53
488	6602318.62	4701959.67
489	6601957.57	4702293.61
490	6601922.32	4701828.97
491	6601861.31	4701792.36
492	6601996.41	4702349.27
493	6602022.85	4702393.16
494	6602403.41	4701604.36
495	6602097.74	4701906.62
496	6602516.92	4701698.09
497	6602214.56	4702104.96
498	6601972.38	4701947.00

499	6602129.11	4701893.03
500	6601955.92	4702191.35
501	6601967.03	4702180.02
502	6602284.21	4701882.68
503	6601934.43	4701980.84
504	6601935.32	4701975.22
505	6602471.75	4701688.82
506	6602014.97	4701916.60
507	6602331.42	4701938.27
508	6602226.89	4701869.10
509	6601821.16	4701812.89
510	6601933.94	4702264.20
511	6601991.91	4702202.43
512	6601783.43	4701828.62
513	6601814.76	4701812.77
514	6602197.72	4701888.30
515	6602214.13	4701888.65
516	6603161.48	4701083.72
517	6601891.18	4702016.90
518	6601939.13	4701829.40
519	6601995.43	4701923.65
520	6602001.68	4701924.92
521	6601988.24	4701929.08
522	6601927.96	4701837.59
523	6602007.29	4701932.01
524	6602006.31	4701938.64
525	6602153.95	4701877.32
526	6601869.62	4701784.19
527	6601905.66	4701864.13
528	6601917.99	4701883.78
529	6601999.78	4701944.08
530	6602183.09	4701905.64
531	6602169.74	4701921.53
532	6602086.24	4702020.93
533	6602128.67	4701970.42
534	6601915.85	4702225.81
535	6601966.21	4701815.56
536	6601829.07	4701805.53
537	6601852.66	4701793.59
538	6601966.07	4702222.73
539	6601992.70	4701942.27
540	6602025.14	4701971.48

541	6601888.76	4701777.47
542	6601882.61	4701776.11
543	6601946.60	4701969.95
544	6601843.36	4702058.55
545	6602030.69	4701907.29
546	6601779.74	4701833.85
547	6601987.18	4701935.16
548	6601964.46	4701946.88
549	6602235.80	4701858.88
550	6602527.47	4701494.43
551	6602618.38	4701540.53
552	6602609.06	4701548.02
553	6602277.65	4701894.61
554	6601973.77	4702180.28
555	6602113.58	4701863.38
556	6602143.08	4701834.64
557	6602076.00	4702027.67
558	6601978.14	4702024.28
559	6601972.93	4701958.47
560	6601918.74	4701994.79
561	6601924.75	4701989.50
562	6601883.03	4702015.70
563	6601892.50	4702033.45
564	6601826.18	4701813.07
565	6602793.24	4701408.77
566	6602080.73	4702022.04
567	6602024.62	4701962.56
568	6601991.88	4701990.86
569	6603164.02	4701053.07
570	6603175.45	4701077.35
571	6602311.75	4701960.71
572	6602075.92	4701923.50
573	6601878.84	4702036.69
574	6602753.38	4701438.22
575	6602074.87	4702034.45
576	6601963.86	4702165.18
577	6601937.95	4701989.77
578	6601930.68	4701996.27
579	6602020.44	4701966.14
580	6601834.17	4702063.73
581	6602676.94	4701566.31
582	6601960.36	4701957.64

583	6601891.05	4702047.42
584	6601886.87	4702037.97
585	6601906.56	4702213.76
586	6601865.81	4701887.03
587	6601960.10	4702153.11
588	6602031.29	4702081.22
589	6602036.69	4702079.99
590	6602611.66	4701538.11
591	6602128.58	4701961.94
592	6601932.34	4702202.11
593	6601895.39	4701903.74
594	6601867.65	4701983.53
595	6602610.80	4701612.31
596	6602029.22	4701967.79
597	6601949.59	4702184.95
598	6601962.44	4702171.79
599	6601832.54	4702070.00
600	6602531.50	4701500.01
601	6602511.75	4701471.64
602	6602101.49	4701952.96
603	6602773.99	4701424.88
604	6601894.59	4702025.58
605	6601999.93	4702000.28
606	6601991.64	4702040.70
607	6601944.57	4701990.46
608	6601903.01	4702068.52
609	6602902.12	4701373.80
610	6602040.61	4702075.24
611	6602534.28	4701492.71
612	6602530.72	4701488.02
613	6601960.77	4701951.28
614	6601951.05	4701978.05
615	6601950.42	4701984.07
616	6602025.90	4702093.83
617	6602831.82	4701459.48
618	6602025.09	4701921.14
619	6601896.08	4702045.20
620	6601907.50	4702065.35
621	6601969.76	4702158.76
622	6601913.45	4702216.72
623	6602513.38	4701465.49
624	6602054.93	4701903.42

625	6602019.52	4701924.36
626	6602488.06	4701489.16
627	6602885.31	4701346.61
628	6601949.01	4702133.70
629	6602172.41	4701937.79
630	6602269.95	4702013.39
631	6601956.00	4701819.99
632	6602601.11	4701625.89
633	6602192.90	4702010.82
634	6602675.37	4701571.70
635	6602025.77	4702088.30
636	6602090.22	4701911.56
637	6602079.37	4701895.05
638	6601973.71	4702027.53
639	6602621.69	4701514.36
640	6602542.54	4701516.74
641	6601924.63	4702001.60
642	6602901.96	4701381.37
643	6602572.42	4701417.92
644	6601998.24	4701989.75
645	6602046.03	4702068.79
646	6601976.26	4702156.76
647	6602766.39	4701507.55
648	6602637.62	4701423.04
649	6602071.98	4701893.33
650	6601875.83	4701999.43
651	6602609.88	4701618.80
652	6602475.08	4701735.36
653	6602677.11	4701482.76
654	6602647.83	4701352.32
655	6602810.19	4701474.79
656	6602843.73	4701453.03
657	6601987.59	4702044.41
658	6602880.88	4701344.03
659	6602162.27	4701944.42
660	6602602.72	4701388.09
661	6602200.05	4701899.44
662	6602542.82	4701443.75
663	6602204.73	4701893.95
664	6602265.18	4701935.22
665	6602854.52	4701440.60
666	6602306.40	4701970.17

667	6602778.31	4701493.49
668	6602266.96	4702025.25
669	6602860.76	4701436.48
670	6602358.27	4701684.34
671	6602434.03	4701772.51
672	6601938.43	4701969.63
673	6601900.39	4701904.38
674	6602261.40	4701928.64
675	6602275.98	4702010.10
676	6602280.20	4702003.01
677	6602411.49	4701800.84
678	6602645.98	4701357.80
679	6602240.38	4702048.57
680	6602245.18	4702052.22
681	6602662.82	4701580.54
682	6602210.30	4701892.95
683	6602417.87	4701794.13
684	6602433.48	4701778.09
685	6602147.98	4701961.42
686	6602148.26	4701970.10
687	6602681.59	4701563.03
688	6602270.72	4701820.63
689	6602786.00	4701489.44
690	6602791.60	4701489.77
691	6602620.89	4701610.33
692	6602616.52	4701607.84
693	6601965.11	4702150.85
694	6602756.13	4701510.49
695	6602262.87	4701749.40
696	6602019.61	4702102.50
697	6602632.18	4701602.14
698	6602753.31	4701516.76
699	6602173.53	4701931.01
700	6602318.04	4701653.44
701	6602751.24	4701445.42
702	6602573.88	4701412.09
703	6602298.88	4701753.33
704	6602453.90	4701755.19
705	6602391.96	4701687.73
706	6602307.20	4701964.66
707	6602777.29	4701499.86
708	6602349.94	4701685.96

709	6602669.22	4701478.85
710	6602485.54	4701496.20
711	6602816.17	4701393.75
712	6602439.12	4701765.36
713	6602207.93	4702165.38
714	6602538.31	4701519.70
715	6602526.42	4701503.81
716	6602688.97	4701494.29
717	6601953.50	4702130.53
718	6602252.39	4702049.75
719	6602533.15	4701551.94
720	6602291.87	4701787.84
721	6602288.25	4701766.43
722	6602227.08	4701792.48
723	6602266.98	4702018.38
724	6602000.40	4702058.39
725	6601972.15	4702081.25
726	6602392.55	4701632.75
727	6602226.21	4702186.47
728	6602224.45	4702180.62
729	6602666.72	4701343.62
730	6602660.39	4701342.72
731	6602287.61	4701771.48
732	6602693.74	4701496.57
733	6602358.31	4701872.41
734	6602361.43	4701867.24
735	6602134.43	4702165.53
736	6602256.33	4701815.26
737	6602383.26	4701633.44
738	6602686.53	4701501.59
739	6602328.96	4701653.78
740	6602340.07	4701684.86
741	6602324.21	4701728.69
742	6602688.45	4701562.48
743	6602372.46	4701843.76
744	6602377.83	4701842.20
745	6602563.42	4701653.54
746	6602368.91	4701855.32
747	6602368.39	4701849.75
748	6602476.96	4701539.90
749	6602250.88	4701951.07
750	6602246.42	4701947.60

751	6602653.43	4701409.72
752	6602185.00	4702141.23
753	6602189.37	4702219.38
754	6602351.09	4701875.05
755	6602134.94	4702173.60
756	6602547.90	4701671.49
757	6602852.83	4701445.50
758	6602281.95	4701796.28
759	6602270.38	4701813.12
760	6602400.94	4701812.64
761	6602359.89	4701670.19
762	6602208.47	4702202.80
763	6602218.35	4702193.62
764	6602479.36	4701724.94
765	6602567.74	4701649.83

766	6602274.53	4701791.18
767	6602324.22	4701735.62
768	6602181.55	4702137.08
769	6602173.32	4702136.13
770	6602315.90	4701742.50
771	6602294.46	4701777.47
772	6602608.16	4701387.09
773	6602542.29	4701671.69
774	6602402.17	4701805.91
775	6602088.39	4701891.74
776	6602321.12	4701740.61
777	6602463.44	4701512.99
778	6602462.32	4701523.30
779	6602562.37	4701659.05
780	6602588.95	4701636.23

781	6602437.67	4701559.91
782	6602465.38	4701532.67
783	6602574.51	4701648.63
784	6602285.68	4701790.80
785	6602363.69	4701661.67
786	6602590.85	4701629.26
787	6602544.31	4701566.02
788	6602344.22	4701678.08
789	6602343.58	4701670.34
790	6602456.54	4701532.59
791	6602442.60	4701547.53
792	6602445.72	4701765.52
793	6602183.33	4702219.25
794	6602437.49	4701553.39
795	6602361.05	4701676.91

Crna Gora
Glavni Grad Podgorica
**Sekretarijat za planiranje prostora i
održivi razvoj**

Broj: 08-332/20-547
Podgorica, 20.07.2020.godine

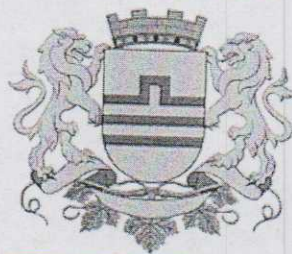

GRAFIČKI PRILOG –Plan saobraćajne infrastrukture

Izvod iz DUP-a „Momišići B “ u Podgorici
za urbanističku parcelu UP B244

05

PRESJEK 5b-5b

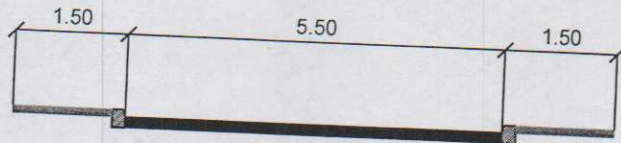

PRESJEK 5a-5a

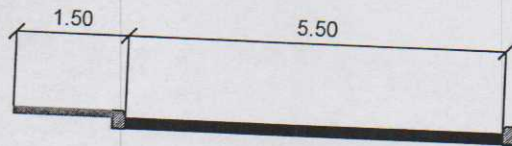

PRESJEK 5.50-5.50

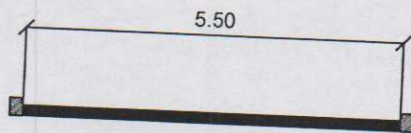

PRESJEK 4.75a-4.75a

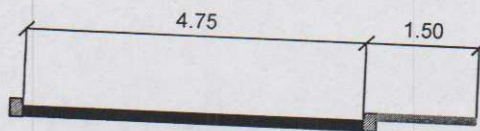

PRESJEK 4-4

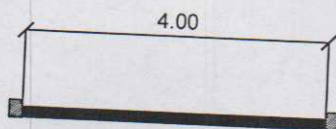

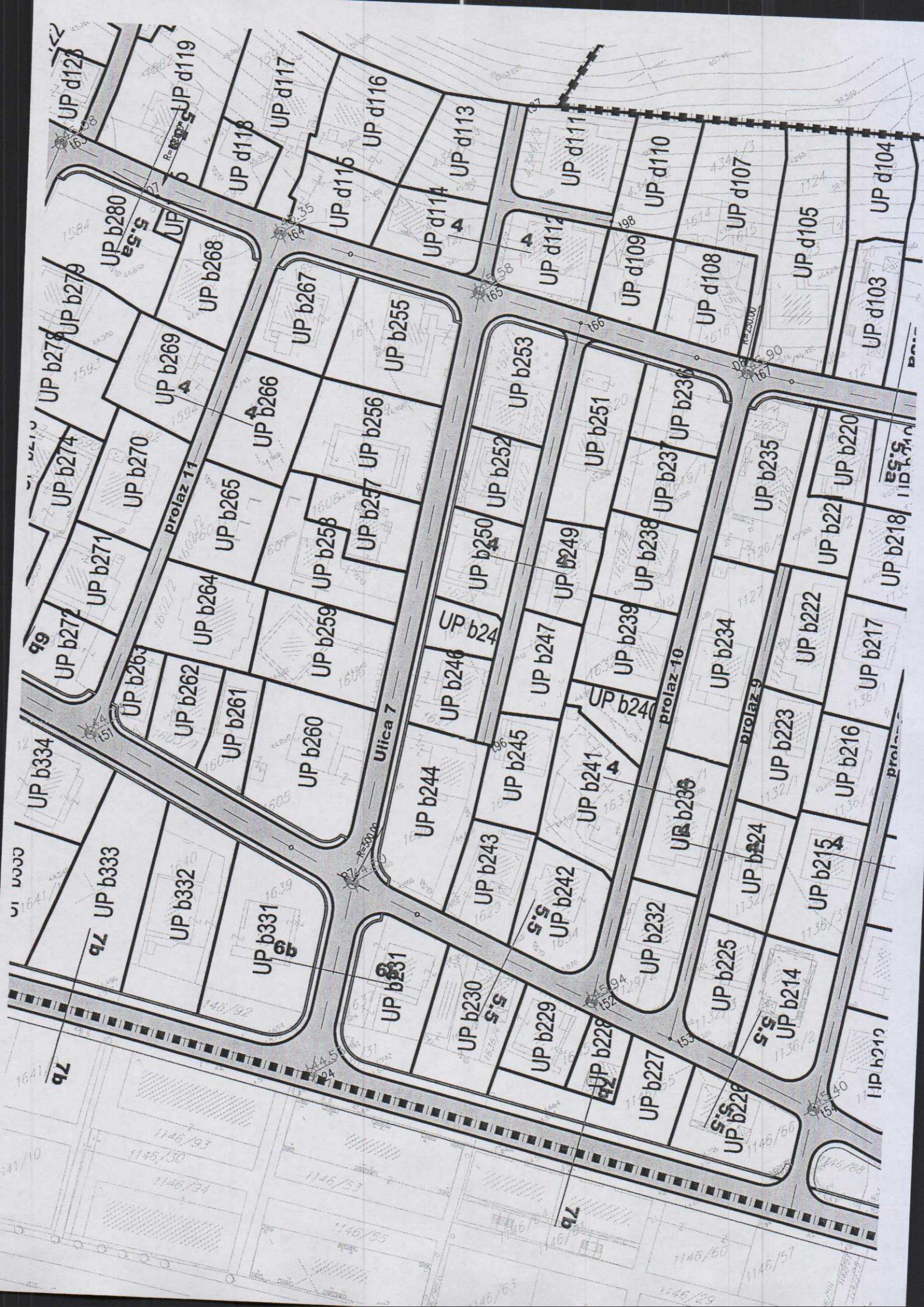

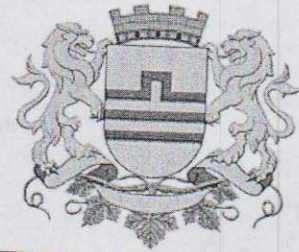

GRAFIČKI PRILOG –Plan elektroenergetske infrastrukture

Izvod iz DUP-a „Momišići B “ u Podgorici
 za urbanističku parcelu UP B244



LEGENDA:



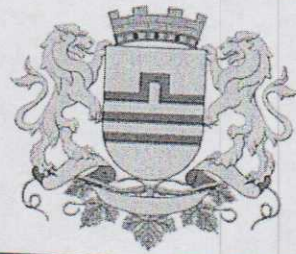

- ■ ■ ■ ■ Granica zahvata DUP-a
- Postojeći vodovod
- - - Planirani vodovod
- Vodovod - ukida se
- ▲ Postojeća fekalna kanalizacija
- ▲ Planirana fekalna kanalizacija
- - - Fekalna kanalizacija - ukida se
- ▶ Smjer odvođenja
- ▲ Postojeća atmosferska kanalizacija
- - - Planirana atmosferska kanalizacija
- ▶ Smjer odvođenja

GRAFIČKI PRILOG –Plan hidrotehničke infrastrukture

Izvod iz DUP-a „Momišići B“ u Podgorici
 za urbanističku parcelu UP B244



LEGENDA:

-  Granica zahvata DUP-a
-  Tk okno - Postojeće kablovsko okno
-  TK podzemni vod - Postojeća elektronska komunikaciona infrastruktura
-  Planirano Tk okno - Planirano kablovsko okno NO 1,....NO 250
-  Planirani TK podzemni vod - Planirana elektronska komunikaciona infrastruktura sa 4 PVC cijevi 110mm

GRAFIČKI PRILOG –Plan telekomunikacione infrastrukture

Izvod iz DUP-a „Momišići B“ u Podgorici
 za urbanističku parcelu UP B244

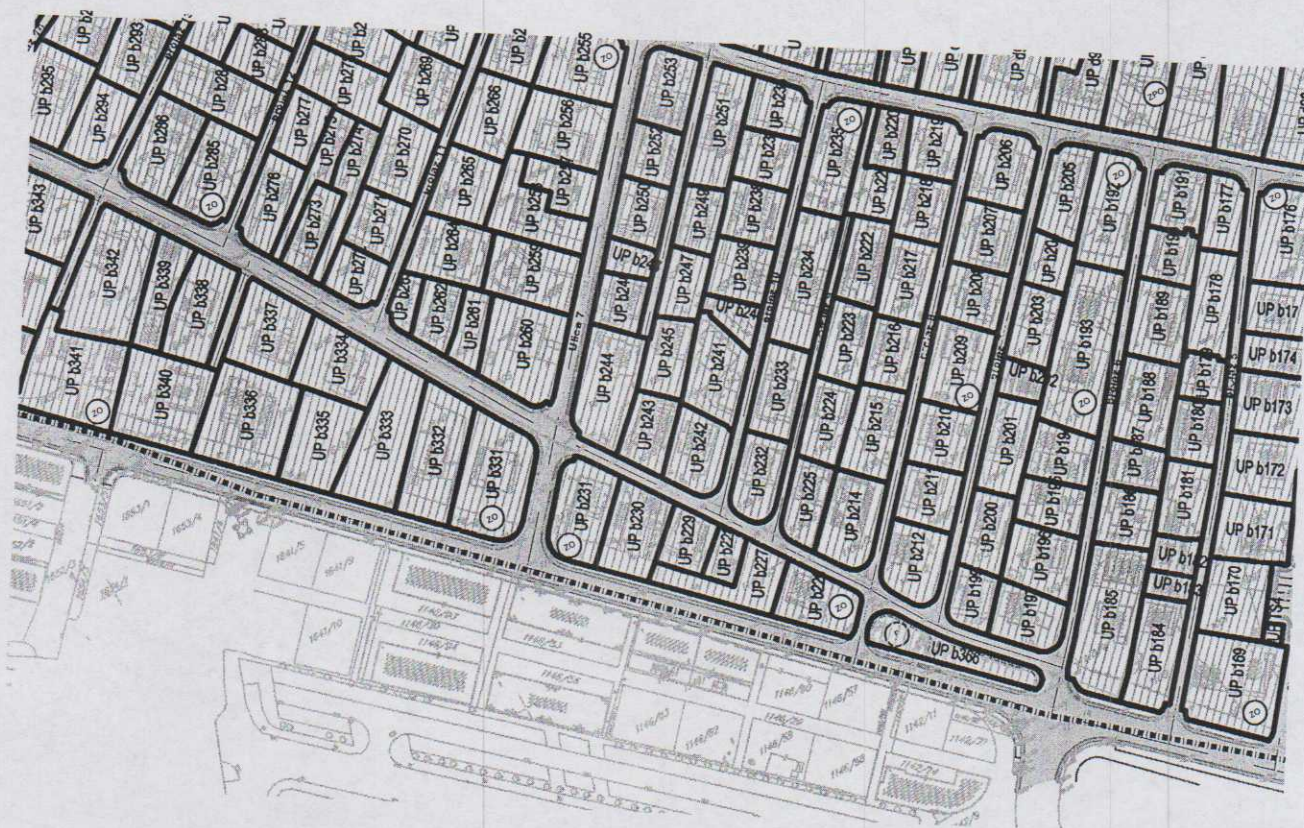

ZELENILO INDIVIDUALNIH STAMBENIH OBJEKATA